

LEGAL DESCRIPTION OF ALLEY VACATION WITH RETAINED UTILITY EASEMENT

All that part of the 16 foot wide platted Alley lying between Block 77 and Block 80, WEST DULUTH SIXTH DIVISION, according to the recorded plat thereof, St. Louis County, Minnesota.

Said Alley vacation contains 6,000 square feet or 0.14 acres.

SURVEYOR'S NOTES

1. THIS SURVEY HAS BEEN PREPARED WITHOUT BENEFIT OF A TITLE COMMITMENT OR TITLE OPINION. A TITLE SEARCH FOR RECORDED OR UNRECORDED EASEMENTS WHICH MAY BENEFIT OR ENCUMBER THIS PROPERTY HAS NOT BEEN COMPLETED BY ALTA LAND SURVEY COMPANY. THE SURVEYOR ASSUMES NO RESPONSIBILITY FOR SHOWING THE LOCATION OF RECORDED OR UNRECORDED EASEMENTS OR OTHER ENCUMBRANCES NOT PROVIDED TO THE SURVEYOR AS OF THE DATE OF THE SURVEY.
2. THIS IS NOT A BOUNDARY SURVEY.

Approved by the City Engineer of the City of Duluth, MN this 25 day of Feb 2020

By [Signature]

I hereby certify that this survey, plan, or report was prepared by me or under my direct supervision and that I am a duly Licensed Land Surveyor under the laws of the State of Minnesota.

[Signature]
David R. Evanson
DATE: 01-31-2020 MN Lic. No. 49505

ALLEY VACATION EXHIBIT

CLIENT: NORTHLAND CONSULTING
ENGINEERS
ADDRESS: N 57TH AVENUE WEST
DULUTH, MN
DATE: 01-31-2020

REVISIONS:



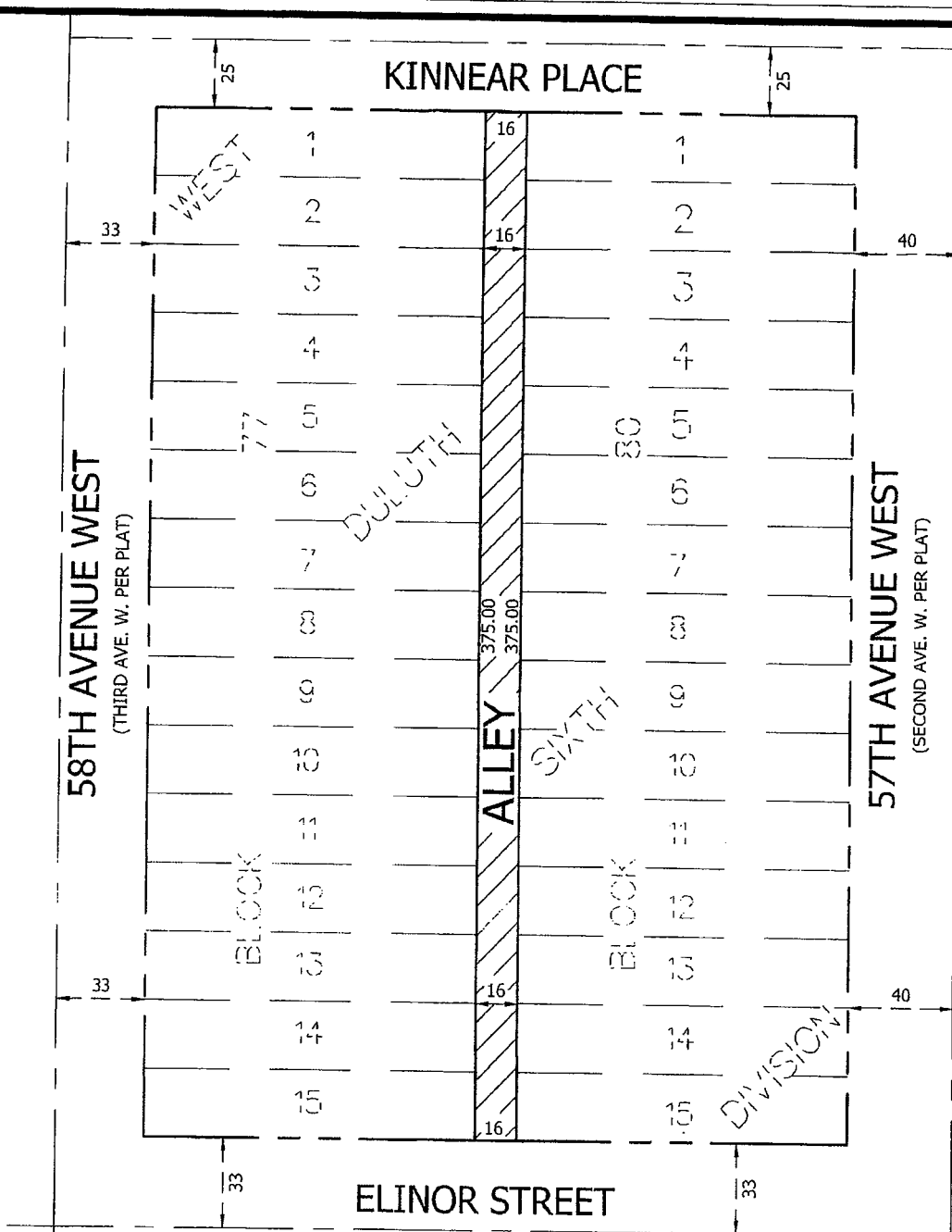

JOB NO: 19-349 SHEET 1 OF 2

ALTA
LAND SURVEY COMPANY

PHONE: 218-727-5211
LICENSED IN MN & WI
WWW.ALTLANDSURVEYDULUTH.COM



LEGEND

-  CENTER LINE
-  RIGHT OF WAY LINE
-  PLAT LINE
-  ALLEY VACATION WITH RETAINED UTILITY EASEMENT

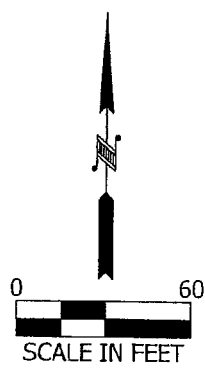

ALLEY VACATION EXHIBIT	
CLIENT: NORTHLAND CONSULTING ENGINEERS ADDRESS: N 57TH AND N 58TH AVENUE WEST, DULUTH, MN 55807 DATE: 01-31-2020	REVISIONS: JOB NO: 19-349
SHEET 2 OF 2	

ALTA
LAND SURVEY COMPANY

PHONE: 218-727-5211
LICENSED IN MN & WI
WWW.ALTLANDSURVEYDULUTH.COM