

PLOT DATE: Apr 08, 2019 - 11:34am
 FILE NAME: P:\Herman\work\Official\Projects\TKDA\15513_349 UMID DT Trail\04_Production\01_CAD\01_3x66\UMID Vacation Exhibit.dwg

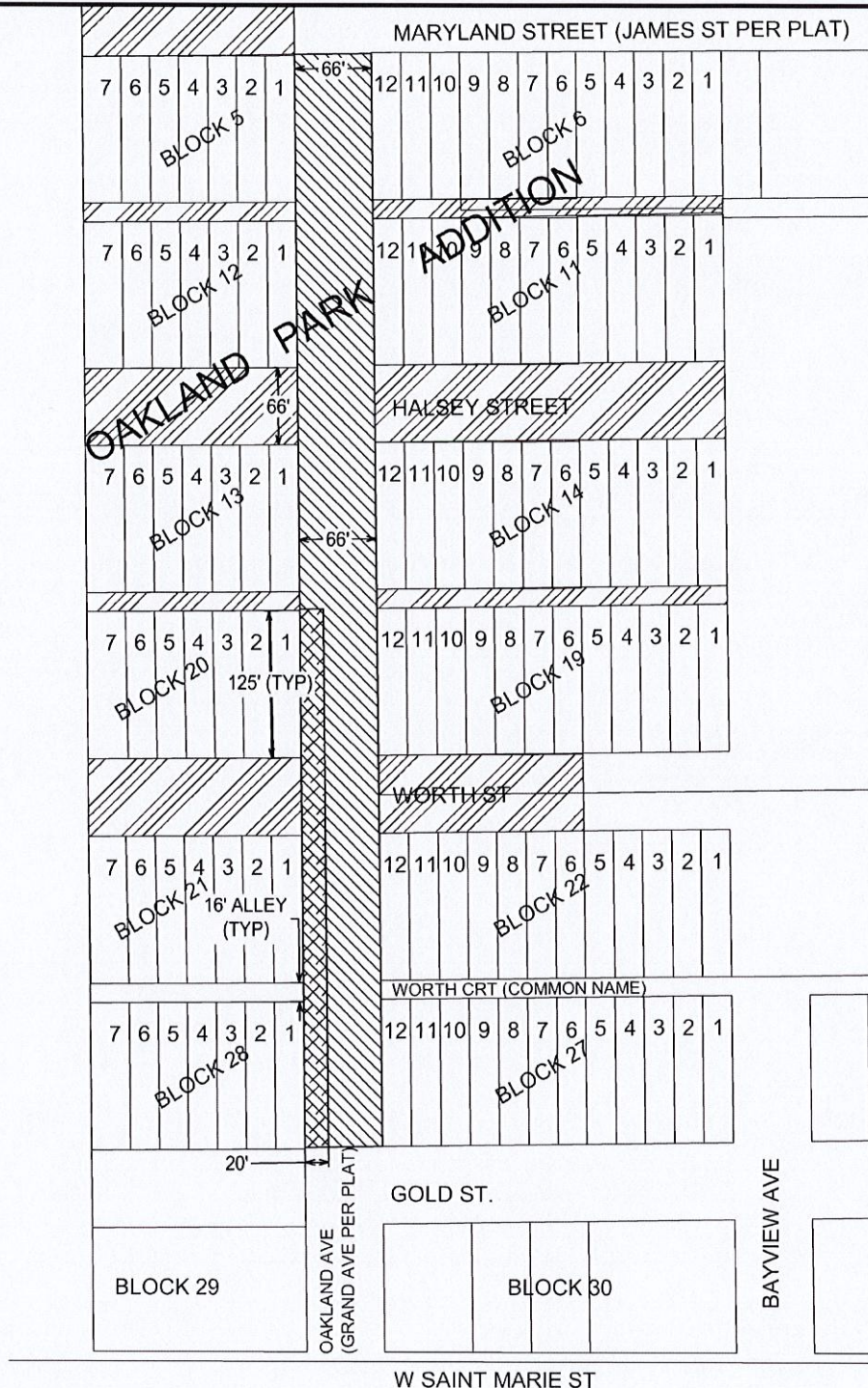

PORTION TO BE VACATED IS SHOWN AS:
 PORTION TO BE VACATED WITH UTILITY EASEMENT RETAINED IS SHOWN AS:
 PREVIOUSLY VACATED RIGHT OF WAY

APPROVED BY THE CITY ENGINEER OF DULUTH, MN
 DATE: 4-11-19 BY: *[Signature]*

BAR IS ONE INCH ON ORIGINAL DRAWING. IF NOT ONE INCH ON THIS DRAWING ADJUST SCALES ACCORDINGLY.

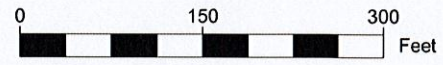
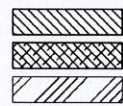

TKDA
 11 E. Superior Street, Suite 420
 Duluth, MN 55802
 218.724.8578
 tkda.com

I HEREBY CERTIFY THAT THIS PLAN, SPECIFICATION, OR REPORT WAS PREPARED BY ME OR UNDER MY DIRECT SUPERVISION AND THAT I AM A DULY LICENSED SURVEYOR UNDER THE LAWS OF THE STATE OF MINNESOTA.
[Signature]
 GREGORY STOEWER DATE 04/08/2019

OAKLAND PARK ADDITION: OAKLAND AVENUE VACATION MARYLAND STREET TO GOLD STREET	15513.349
CITY OF DULUTH	SHEET 1 OF 2

Legal Description of Vacation:

That portion of Oakland Avenue (Grand Avenue per plat) of Oakland Park Addition according to the recorded plat thereof, St. Louis County, Minnesota, which lies between the south line of Maryland Street (James Street per plat) and the extension of the southern line of Block 27 Oakland Park Addition.

AND

Legal Description of Utility Easement to be Retained:

The western most 20 foot strip of said vacated Oakland Avenue (Grand Avenue per plat) which lies between the extension of the northern line of Block 20 and the extension of the southern line of Block 28 Oakland Park Addition is to be retained for utility easement purposes.

PLOT DATE: Apr 08, 2019 - 11:34am
FILE NAME: P:\hermantown-office\Projects\TKDA\15513 Land Surveys\15513.349 UMD DT Trail\04_Production\01_CAD\01_Xref\15513.349 UMD Vacation Exhibit.dwg

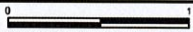

BAR IS ONE INCH ON ORIGINAL DRAWING. IF NOT ONE INCH ON THIS DRAWING ADJUST SCALES ACCORDINGLY.



11 E. Superior Street, Suite 420
Duluth, MN 55802
218.724.8578
tkda.com

I HEREBY CERTIFY THAT THIS PLAN, SPECIFICATION, OR REPORT WAS PREPARED BY ME OR UNDER MY DIRECT SUPERVISION AND THAT I AM A DULY LICENSED SURVEYOR UNDER THE LAWS OF THE STATE OF MINNESOTA.

Gregory Stoeber
GREGORY STOEWER

DATE 04/08/2019

OAKLAND PARK ADDITION: OAKLAND AVENUE VACATION
MARYLAND STREET TO GOLD STREET

15513.349

CITY OF DULUTH

SHEET 2 OF 2