

Save: 4/13/2023 1:38 PM aorleskie Plot: 4/13/2023 3:20 PM X:\AED\DLUT\159621\5-final-dgn\51-drawings\10-Civil\caddwg\sheetDU159621.TL1.dwg

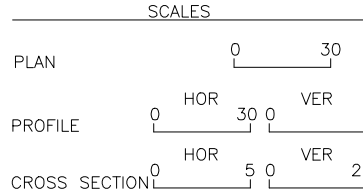
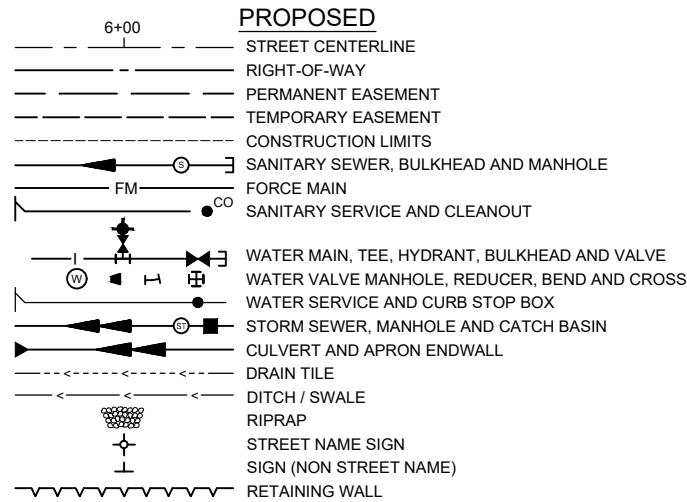
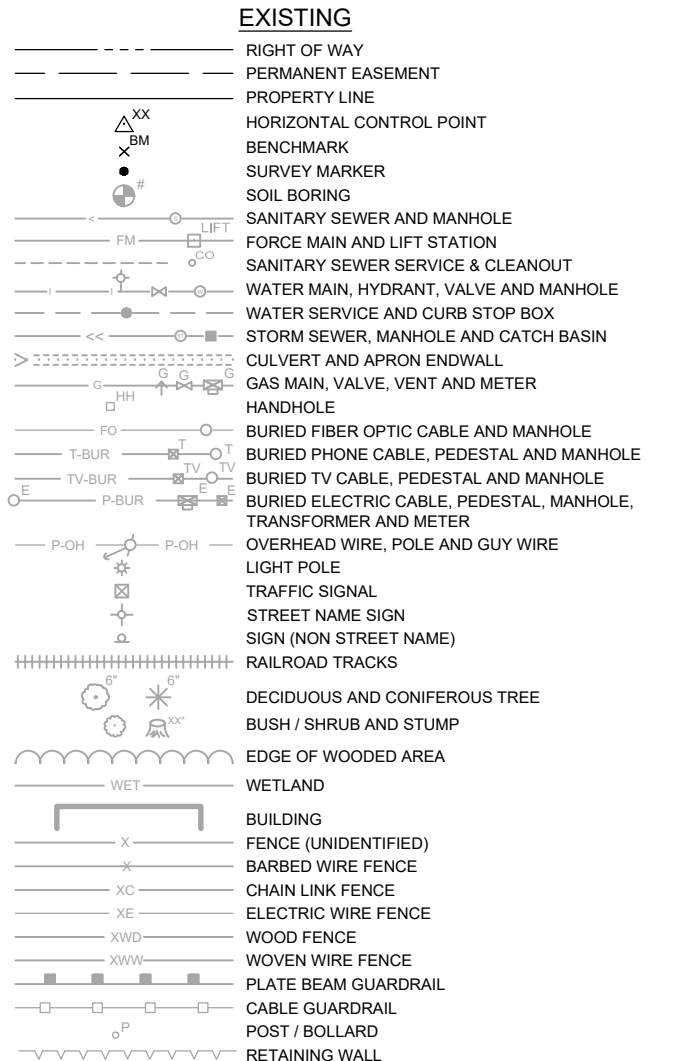

NOTE:
THE SUBSURFACE UTILITY QUALITY INFORMATION IN THIS PLAN IS LEVEL D.
THIS UTILITY QUALITY LEVEL WAS DETERMINED ACCORDING TO THE
GUIDELINES OF C/ASCE 38-02 ENTITLED "STANDARD GUIDELINES FOR THE
COLLECTION AND DEPICTION OF EXISTING SUBSURFACE UTILITY DATA."

THE CONTRACTOR SHALL CALL THE ONE CALL SYSTEM AT
811 BEFORE COMMENCING EXCAVATION.

MINNESOTA DEPARTMENT OF TRANSPORTATION CITY OF DULUTH, MINNESOTA

CONSTRUCTION PLANS FOR GRADING, BITUMINOUS SURFACING, AND ADA IMPROVEMENTS

CROSS CITY TRAIL - PHASE 3

CITY PROJECT NO. 1510
SP 118-090-026
FROM: CENTRAL AVENUE
TO: 59TH WEST TO RALEIGH STREET
AND
FROM: EAST SIDE OF KINGSBURY CREEK BRIDGE
TO: GRAND AVENUE (MN23) IN THE CITY OF DULUTH

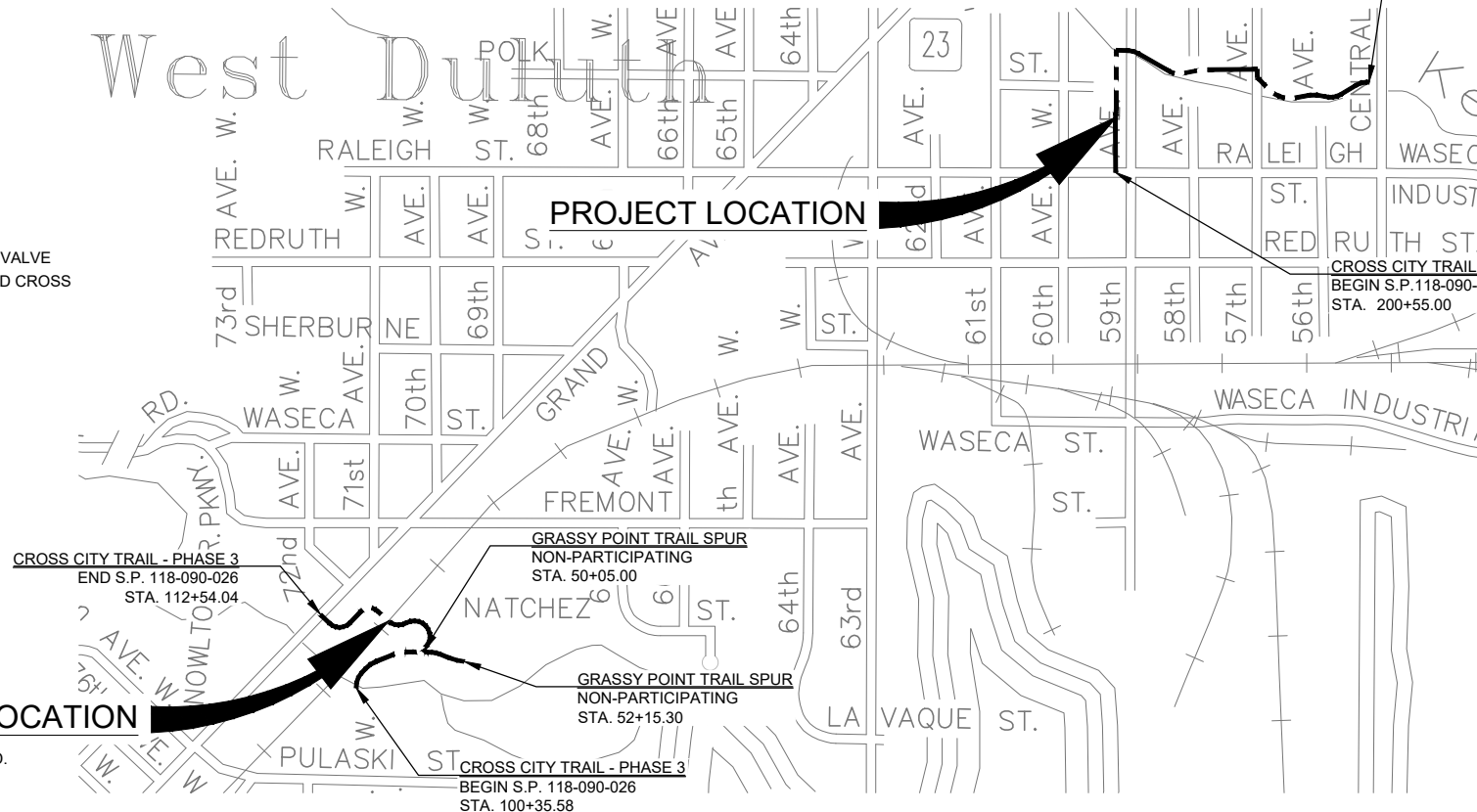



CROSS CITY TRAIL - PHASE 3
END S.P. 118-090-026
STA. 221+06.13

CROSS CITY TRAIL - PHASE 3
BEGIN S.P. 118-090-026
STA. 200+55.00

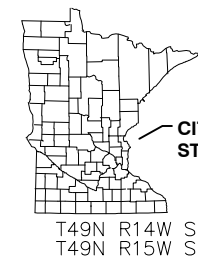

PROJECT LOCATION



MINN. PROJ. NO. TA 6923(261)	
GOVERNING SPECIFICATIONS THE 2020 EDITION OF THE MINNESOTA DEPARTMENT OF TRANSPORTATION "STANDARD SPECIFICATIONS FOR CONSTRUCTION" AND THE "SUPPLEMENTAL SPECIFICATIONS" DATED SEPTEMBER 2022 SHALL GOVERN.	
THE CURRENT EDITION OF THE CITY OF DULUTH PUBLIC WORKS AND UTILITIES DEPARTMENT STANDARD CONSTRUCTION SPECIFICATIONS AND ALL AMENDMENTS SHALL APPLY.	
ALL TRAFFIC CONTROL DEVICES SHALL CONFORM TO THE LATEST EDITION OF THE MINNESOTA MANUAL ON UNIFORM TRAFFIC CONTROL DEVICES, INCLUDING THE LATEST FIELD MANUAL FOR TEMPORARY TRAFFIC CONTROL ZONE LAYOUTS.	
INDEX	
SHEET NO.	DESCRIPTION
1	TITLE SHEET
2	GENERAL LAYOUT
3	SOILS & CONSTRUCTION NOTES
4	STATEMENT OF ESTIMATED QUANTITIES
5-9	TABULATIONS
10-12	GENERAL ALIGNMENT
13-25	CONSTRUCTION DETAILS
26-28	EXISTING CONDITIONS/REMOVALS
29-31	TYPICAL SECTIONS
32-37	PLAN AND PROFILE
38	STORM SEWER PROFILES
39-41	INTERSECTION DETAIL SHEETS
42-44	EROSION CONTROL PLANS
45-46	SWPPP
47-48	TRAFFIC CONTROL PLAN
49-65	CROSS SECTIONS
THIS PLAN CONTAINS <u>65</u> SHEETS.	
DESIGN DESIGNATION	
STOPPING SIGHT DISTANCE BASED ON: 3.83' HEIGHT OF EYE 0' HEIGHT OF OBJECT	
CROSS CITY TRAIL - PHASE 3 SP 118-090-026	
GROSS LENGTH 3,269.59 FEET 0.619 MILES BRIDGE LENGTH 0 FEET 0.000 MILES EXCEPTION LENGTH 0 FEET 0.000 MILES NET LENGTH 3,269.59 FEET 0.619 MILES DESIGN SPEED 20 M.P.H.	
DESIGN SPEED NOT ACHIEVED AT: EX. 1 STA.108+83.23 TO STA. 109+86.14 - HORIZONTAL CURVE	
APPROVED:	
CITY ENGINEER	DATE
APPROVED:	
CHIEF ENGINEER OF UTILITIES	DATE
RECOMMENDED FOR APPROVAL:	
REVIEWED FOR COMPLIANCE WITH STATE AID AND FEDERAL AID RULES/POLICY - DISTRICT STATE AID ENGINEER	DATE
RECOMMENDED FOR APPROVAL:	
APPROVED FOR STATE AID AND FEDERAL AID FUNDING STATE AID ENGINEER	DATE
DULUTH, MINNESOTA	
 PHONE: 218.279.3000 418 W SUPERIOR ST STE 200 DULUTH, MN 55802-1512 www.sehinc.com	
I HEREBY CERTIFY THAT THIS PLAN WAS PREPARED BY ME OR UNDER MY DIRECT SUPERVISION AND THAT I AM A DULY LICENSED ENGINEER UNDER THE LAWS OF THE STATE OF MINNESOTA.	
PROJECT NO. DULUT-159621	
1 of 65	
Date: 3-29-2023 Lic. No. 43913	
Signature Matthew J. Bolf	
811 Know what's below. Call before you dig.	
SP 118-090-026	