

PHASE 1 – ROAD CLOSURE SIGNING PLAN

NORTHFIELD ST TO REDWING ST

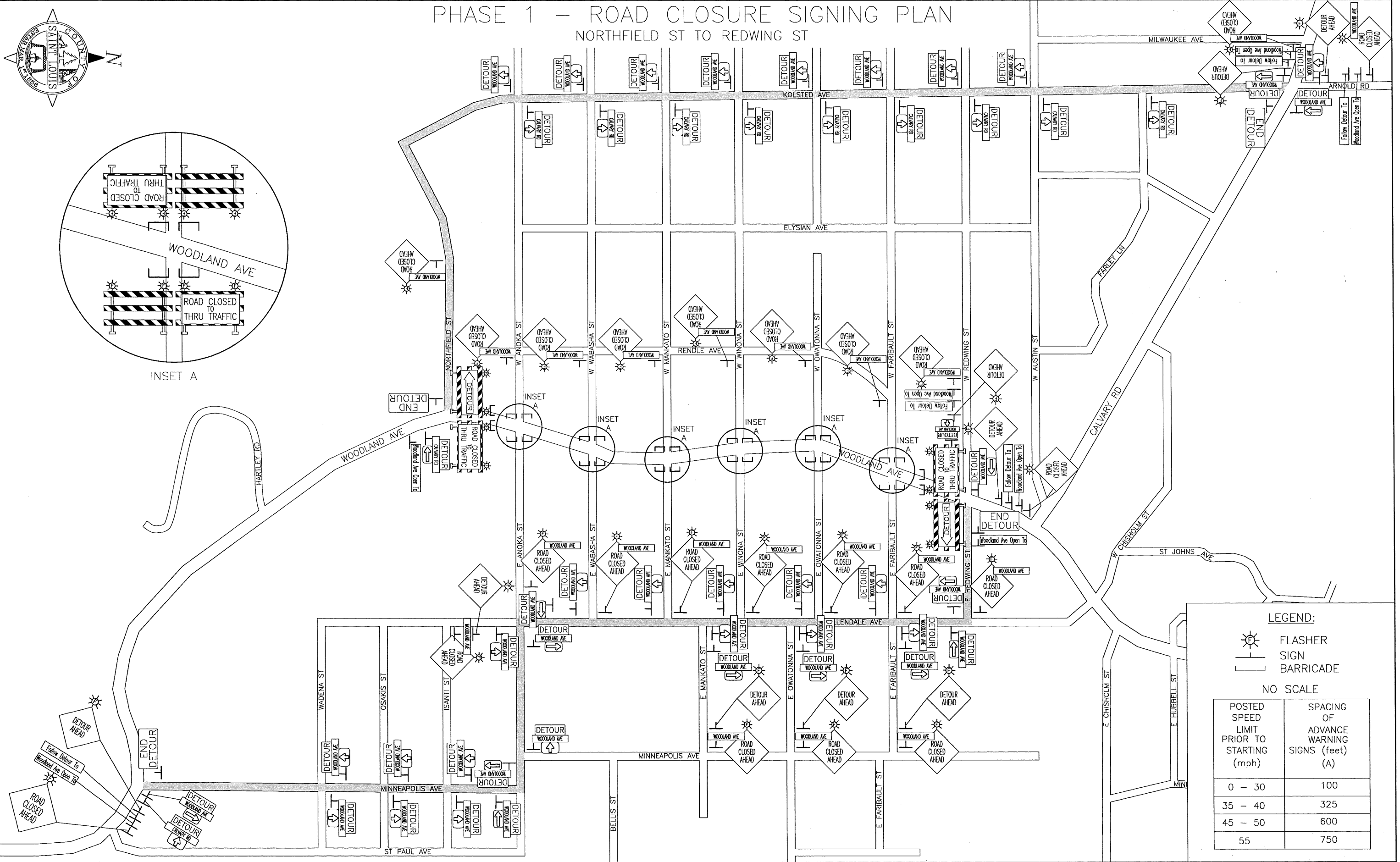
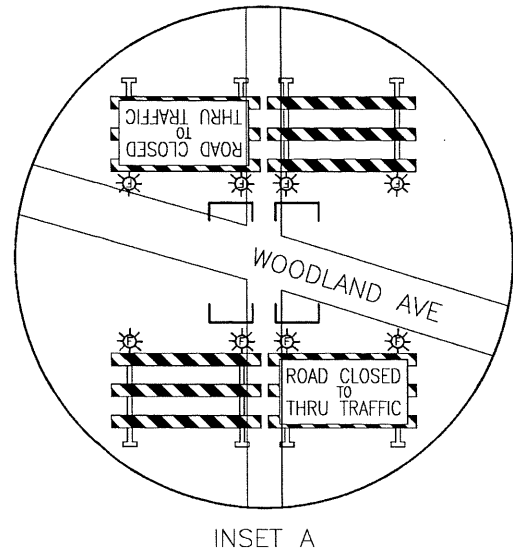
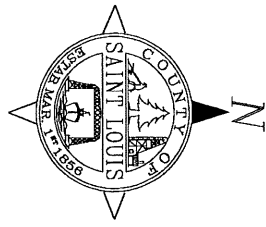

LEGEND:

- FLASHER
- SIGN
- BARRICADE

NO SCALE

POSTED SPEED LIMIT PRIOR TO STARTING (mph)	SPACING OF ADVANCE WARNING SIGNS (feet) (A)
0 - 30	100
35 - 40	325
45 - 50	600
55	750

I HEREBY CERTIFY THAT THIS PLAN SHEET WAS PREPARED BY ME OR UNDER MY DIRECT SUPERVISION AND I AM A DULY LICENSED PROFESSIONAL ENGINEER UNDER THE LAWS OF THE STATE OF MINNESOTA.

STEPHEN E. KRASAWAY
TYPED NAME

45397
LIC. NO.

Stephen Krasaway

2/21/2019
DATE

CP 0009-275996
SAP 069-609-043

TRAFFIC CONTROL PLAN
SHEET 39 OF 229 SHEETS

PHASE 2 – ROAD CLOSURE SIGNING PLAN

REDWING ST TO ALLENDALE AVE/W CHISHOLM ST

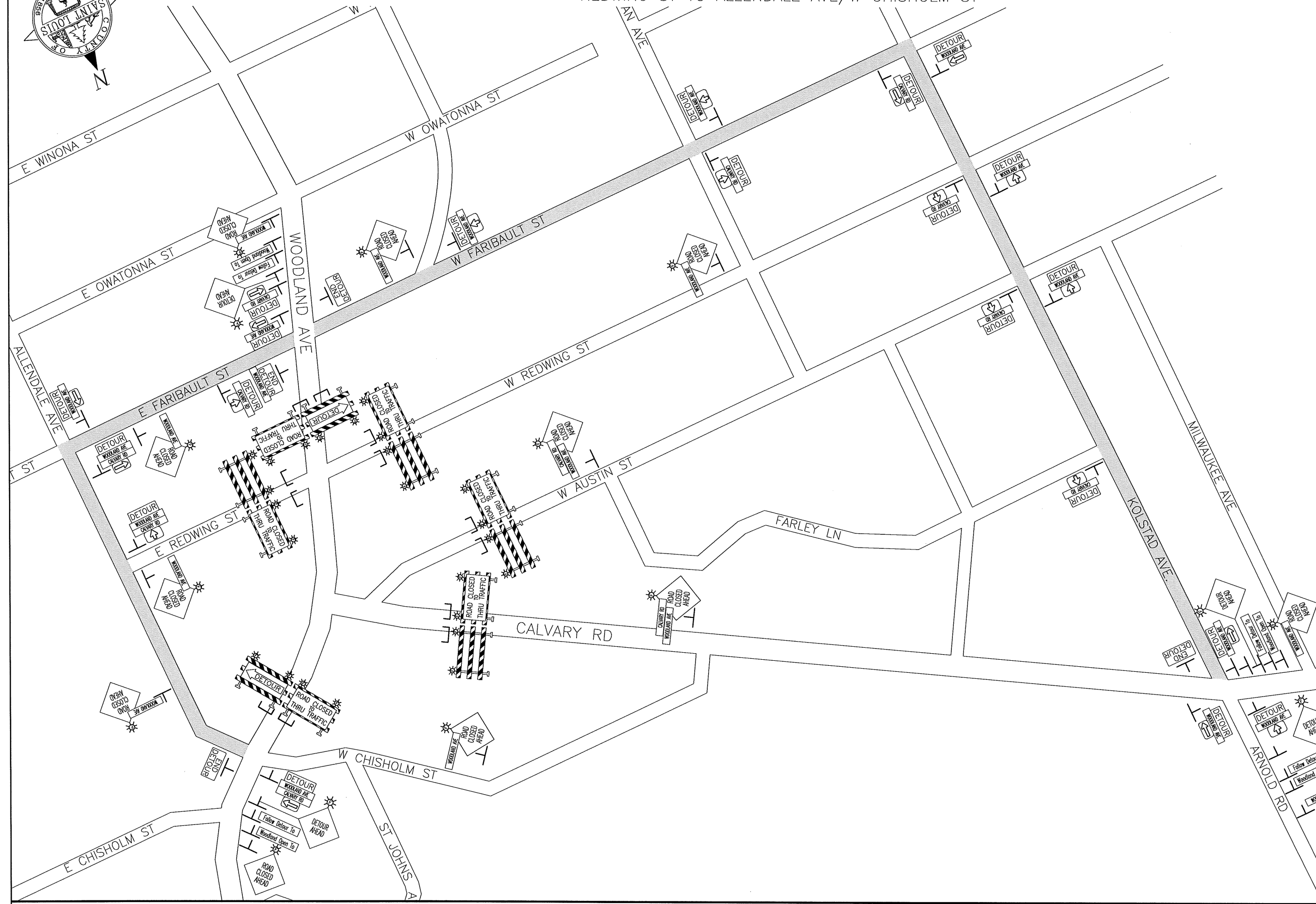
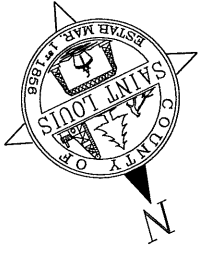

LEGEND:

- FLASHER
- SIGN
- BARRICADE

NO SCALE

POSTED SPEED LIMIT PRIOR TO STARTING (mph)	SPACING OF ADVANCE WARNING SIGNS (feet) (A)
0 - 30	100
35 - 40	325
45 - 50	600
55	750

C:\Projects\45-CPA-CMA-9107-0019-275996\105-Drawings\19-CPA-0019-275996-Traffic Control Plan - C.CONTRC 7 AN.dwg, 2/21/2019, 4:05:00 PM

I HEREBY CERTIFY THAT THIS PLAN SHEET WAS PREPARED BY ME OR UNDER MY DIRECT SUPERVISION AND I AM A DULY LICENSED PROFESSIONAL ENGINEER UNDER THE LAWS OF THE STATE OF MINNESOTA.

STEPHEN E. KRASAWAY
TYPED NAME

45397
LIC. NO.

Stephen Prassany

2/21/2019
DATE

CP 0009-275996
SAP 069-609-043

TRAFFIC CONTROL PLAN
SHEET 41 OF 229 SHEETS

PHASE 3 - ROAD CLOSURE SIGNING PLAN

W AUSTIN ST TO ARNOLD RD

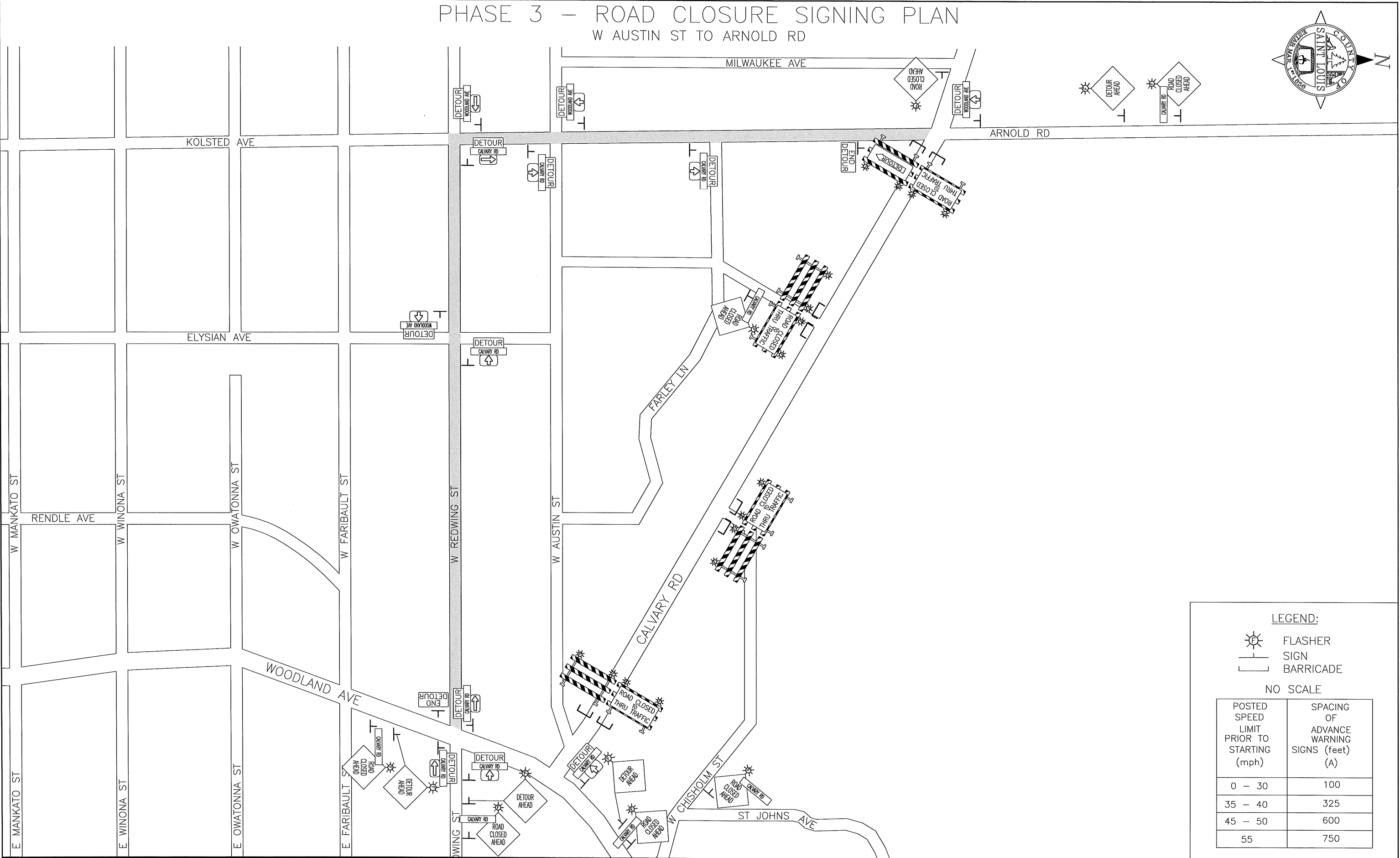
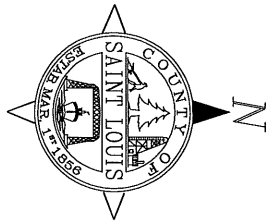

LEGEND:

- FLASHER
- SIGN
- BARRICADE

NO SCALE

POSTED SPEED LIMIT PRIOR TO STARTING (mph)	SPACING OF ADVANCE WARNING SIGNS (feet) (A)
0 - 30	100
35 - 40	325
45 - 50	600
55	750

I HEREBY CERTIFY THAT THIS PLAN SHEET WAS PREPARED BY ME OR UNDER MY DIRECT SUPERVISION AND I AM A DULY LICENSED PROFESSIONAL ENGINEER UNDER THE LAWS OF THE STATE OF MINNESOTA.

STEPHEN E. KRASAWAY
TYPED NAME

45397
LIC. NO.

Stephen Krasaway

2/21/2019
DATE

CP 0009-275996

SAP 069-609-043

TRAFFIC CONTROL PLAN

SHEET 43 OF 229 SHEETS

C:\projects\19-051-8\02-00009-275996\1901 Design\1901 Design\1901 Design\woodland.dwg - 45397.dwg - 2/21/2019 1:36:27 PM