

LEGAL DESCRIPTION:

All that part of East First Street Alley adjacent to Lots 1, 2 and the southwesterly 10.00 feet of Lot 3 and that part of Fourth Avenue East adjacent to the southeasterly 10.00 feet of said Lot 1; all in Block 25, PORTLAND DIVISION OF DULUTH, City of Duluth, St. Louis County, Minnesota.

AND

All that part of East First Street Alley adjacent to Lots 1, 2 and the southwesterly 10.00 feet of Lot 3 and that part of Fourth Avenue East adjacent to the northwesterly 15.00 feet of said Lot 1; all in Block 8, PORTLAND DIVISION OF DULUTH, City of Duluth, St. Louis County, Minnesota.

I hereby certify that this survey, plan, or report was prepared by me or under my direct supervision and that I am a duly Licensed Land Surveyor under the laws of the State of Minnesota.

Paul A. Vogel

Signed _____

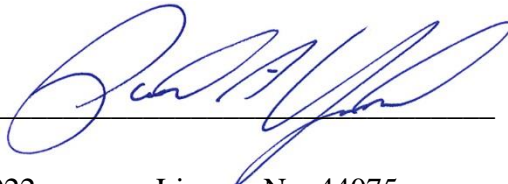

Date 11/05/2022 License No. 44075

EXHIBIT CONCURRENT USE

FIRST STREET ALLEY - SANITARY SEWER SERVICES

Part of Streets and Avenues

PORTLAND DIVISION OF DULUTH

LEGEND

 = CONCURRENT USE AREA

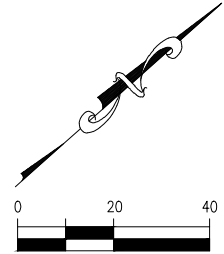

APPROVED BY:

CITY ENGINEER

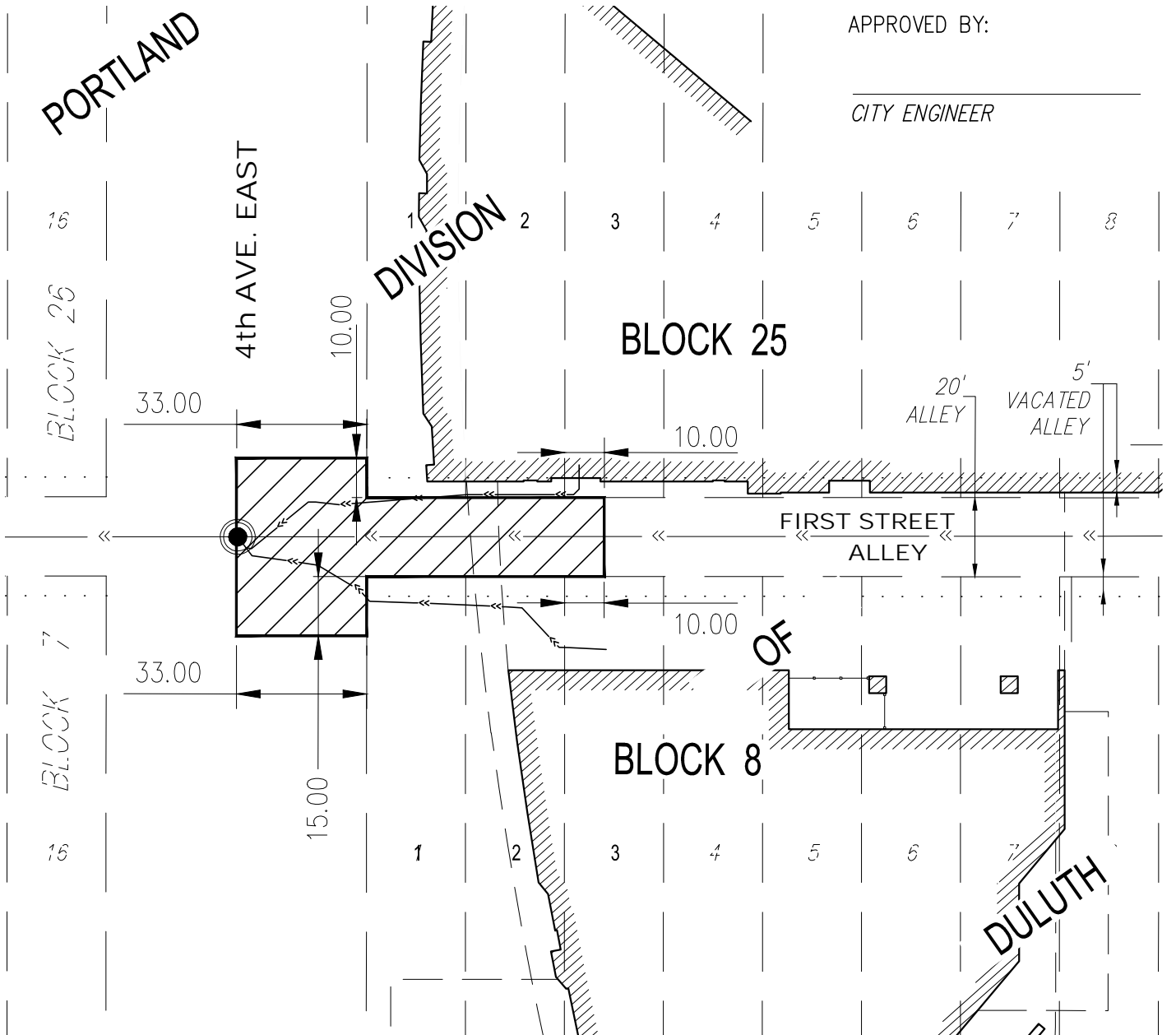

I hereby certify that this plan, specification, or report was prepared by me or under my direct supervision and that I am a duly Licensed Land Surveyor under the laws of the State of Minnesota.

Print Name: Paul A. Vogel

License # 44075

Signature: 

Date: 10/05/2022

DATE PREPARED: 10/05/22

PROJ NO: 180203

FILE: 180203 Concu

SHEET 1 of 1 SHEETS



**PERFORMANCE
DRIVEN DESIGN.**

LHBcorp.com

21 W. Superior St., Ste. 500 | Duluth, MN 55802 | 218.727.8446