

# MINNESOTA DEPARTMENT OF TRANSPORTATION

## SAINT LOUIS COUNTY

CONSTRUCTION PLAN FOR: AGGREGATE BASE, CONCRETE SIDEWALK

LOCATED ON C.S.A.H. 91 (HAINES RD.)  
 BETWEEN U.S. TRUNK HIGHWAY 53 AND ST. LOUIS COUNTY JAIL  
 FROM A POINT APPROX. 2,300' SOUTH OF THE SOUTHWEST TO A POINT APPROX. 1,700' NORTH OF THE SOUTH WEST  
CORNER OF SEC. 07, T50N, R14W. CORNER OF SEC. 07, T50N, R14W.

STATE AID PROJ. NO. 069-691-031

GROSS LENGTH	4110.00	FEET	0.778	MILES
BRIDGES-LENGTH	0.00	FEET	0.000	MILES
EXCEPTIONS-LENGTH	176.00	FEET	0.033	MILES
NET LENGTH	3934.00	FEET	0.745	MILES

### GENERAL LAYOUT

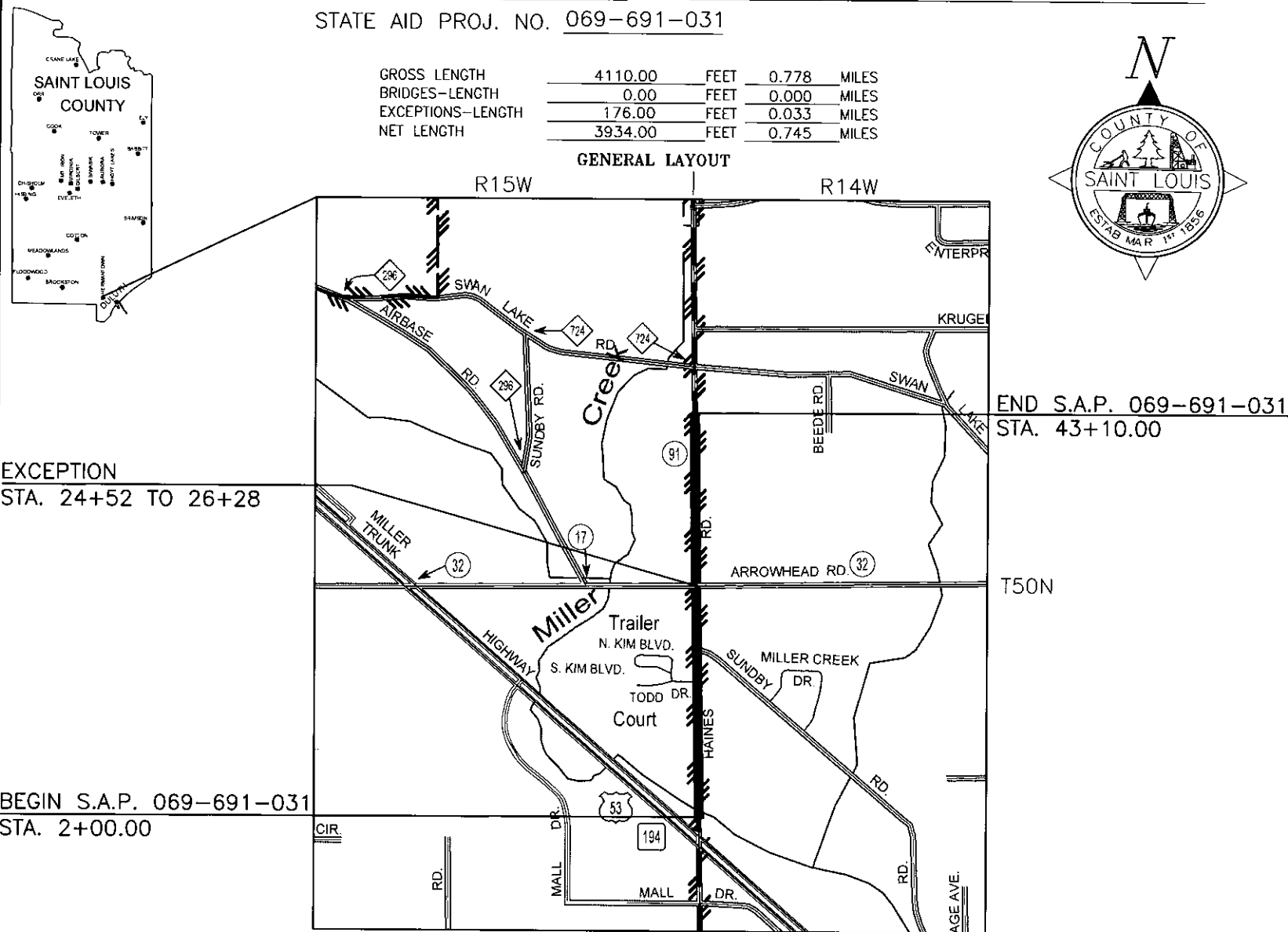

**EXCEPTION**  
 STA. 24+52 TO 26+28

**BEGIN S.A.P. 069-691-031**  
 STA. 2+00.00

**END S.A.P. 069-691-031**  
 STA. 43+10.00

SCALES	
PLAN	30 ft.
INDEX MAP	0.25 mi.

PLAN REVISIONS		
DATE	SHEET NO.	APPROVED BY

PREVIOUS PLANS	

STATE AID PROJ. NO. 069-691-031 CP 0091-340072

MINN. PROJ. NO.

GOVERNING SPECIFICATIONS  
 THE 2018 EDITION OF THE MINNESOTA DEPARTMENT OF TRANSPORTATION  
 "STANDARD SPECIFICATIONS FOR CONSTRUCTION" SHALL GOVERN.

AVAILABLE AT: <http://www.dot.state.mn.us/pre-letting/spec/index.html>

### INDEX OF SHEETS

1	TITLE SHEET AND INDEX MAP
2	ESTIMATED QUANTITIES
3-4	TYPICAL SECTIONS
XX	STANDARD PLANS
XX	QUANTITY CHARTS
XX	TRAFFIC CONTROL PLAN
XX	PLAN SHEETS
XX	EROSION CONTROL (SWPPP)
XX	SIGNING PLAN
XX	CROSS SECTIONS

### DESIGN DESIGNATION

ADT (CURRENT YEAR) 2019	=	9,581
ADT (FUTURE YEAR) 2039	=	10,539
FUNCTIONAL CLASS	=	MINOR ARTERIAL
SIDEWALK	=	6 FT WIDE

DESIGN SQUAD: SOUTH DESIGN

I HEREBY CERTIFY THAT THIS PLAN WAS PREPARED BY ME OR UNDER MY DIRECT SUPERVISION AND THAT I AM A DULY LICENSED PROFESSIONAL ENGINEER UNDER THE LAWS OF THE STATE OF MINNESOTA.

PRINT NAME: STEPHEN E. KRASAWAY

SIGNATURE: \_\_\_\_\_

DATE: \_\_\_\_\_ LIC. NO.: 45397

APPROVED: \_\_\_\_\_ DATE: \_\_\_\_\_  
 ST. LOUIS COUNTY HIGHWAY ENGINEER

DISTRICT STATE AID ENGINEER: REVIEWED FOR COMPLIANCE WITH STATE-AID RULES/POLICY

STATE AID ENGINEER: APPROVED FOR STATE AID FUNDING

SHEET 1 OF XX SHEETS