

K:\Projects\1 - 40 CSAH\CSAH 9\CP 0009-565027\400 Design\410 Drawings\520 Sheets\CP-0009-565027 Title Sheet.dwg

PLAN SYMBOLS

COUNTY LINE	---
TOWNSHIP OR RANGE LINE	=====
SECTION LINE	=====
QUARTER LINE	=====
SIXTEENTH LINE	=====
EXISTING R/W	=====
NEW R/W	=====
TEMP EASE	=====
RAILROAD R/W	=====
UNSURFACED RD. OR SHLD.	-----
EDGE OF LAKE	=====
SWAMP BOUNDARY	=====
MISCELLANEOUS BOUNDARY	=====
CORPORATE OR CITY LIMITS	=====
ALIGNMENT STATIONS	-----
ALIGNMENT POINTS	-----
PROPERTY LINES	-----
VACATED PLATTED PROPERTY	-----
RIVER OR CREEK	=====
DRAINAGE DITCH	=====
BRIDGE	=====
RECREATIONAL TRAIL	=====
RAILROAD (SINGLE TRACK)	=====
RR CROSSING PAVEMENT MARKING	=====
RR CROSSING SIGNAL AND GATE	=====
RR CROSSBUCK SIGN	=====
RR CROSSBUCK SIGN W/LIGHTS	=====
RR SWITCH	=====
BARBED WIRE FENCE	=====
CHAIN LINK FENCE	=====
WOVEN WIRE, OR WOVEN AND BARB	=====
WOOD FENCE	=====
BILLBOARD	=====
GUARD POST	=====
RETAINING WALL	=====
GUARDRAIL (CABLE)	=====
GUARDRAIL (PLATE BEAM)	=====
DRAIN TILE	=====
FLUME	=====
CULVERT APRON	=====
CULVERT	=====
WOODS OR BRUSH, NURSERY	=====
DECIDUOUS TREES	=====
CONIFER (EVERGREEN) TREES	=====
HEDGE	=====
BUSH OR SHRUB	=====
STUMP	=====
SWAMP OR MARSH	=====
CONCRETE OR STONE MONUMENT	=====
IRON PIPE	=====
CAST IRON OR CAPPED PIPE MONUMENT	=====
HUB	=====
NAIL OR SPIKE OR PK NAIL	=====
IRON PIN OR REBAR	=====
IRON PIN WITH BRASS DISK	=====
VERTICAL CONTROL	=====
HORIZONTAL CONTROL	=====
POWER POLE	=====
LIGHT POLE	=====
LIGHT AND TELEPHONE POLE	=====
LIGHT, TELEPHONE AND POWER POLE	=====
GUY POLE	=====
POLE ANCHOR	=====
TELEPHONE POLE	=====
TELEPHONE AND POWER POLE	=====
UNDERGROUND CABLE PEDESTAL	=====
TELEPHONE OR POWER MANHOLE (VAULT)	=====
ELECTRIC CABLE IN CONDUIT	=====
TELEPHONE CABLE IN CONDUIT	=====
BURIED ELECTRIC CABLE	=====
BURIED TELEPHONE CABLE	=====
GAS LINE	=====
GAS METER	=====
WATER LINE	=====
VALVE	=====
FIRE HYDRANT	=====
WATER MANHOLE	=====
WELL	=====
LAWN SPRINKLER HEAD	=====
STORM SEWER MANHOLE	=====
SEPTIC TANK	=====
SANITARY SEWER MANHOLE	=====
CATCH BASIN	=====
FORCE MAIN LIFT STA.	=====
SEWER LINE	=====
BARRICADE	=====
SIGN	=====
TRAFFIC SIGNAL W/MAST ARM	=====
PED. PUSH BUTTON STA.	=====
HAND HOLE	=====
YARD LIGHT	=====
ENTRANCE	=====
BUILDING	=====
SATELLITE DISH	=====
STEEL TOWER	=====
FLAG POLE	=====

MINNESOTA DEPARTMENT OF TRANSPORTATION
SAINT LOUIS COUNTY

CONSTRUCTION PLAN FOR: MILL BITUMINOUS SURFACE, CURB & GUTTER, SIDEWALK SPOT REPLACEMENT,
CONCRETE MEDIANS, WIDENING FOR BUS PULL-OFFS, AND PLANT MIXED
BITUMINOUS SURFACE.

LOCATED ON CSAH 9 (WOODLAND AVE)
BETWEEN CSAH 37 (SINVELY RD) AND ANOKA ST
FROM A POINT APPROXIMATELY 384' WEST AND 3,229' SOUTH TO A POINT APPROXIMATELY 3,649' WEST AND 2,516' NORTH
OF THE NORTHWEST CORNER OF SEC. 12, T50N, R14W.

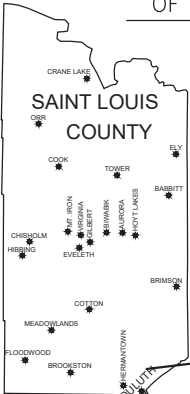

GENERAL LAYOUT

END SP 069-609-050
STA 81+50

T50N

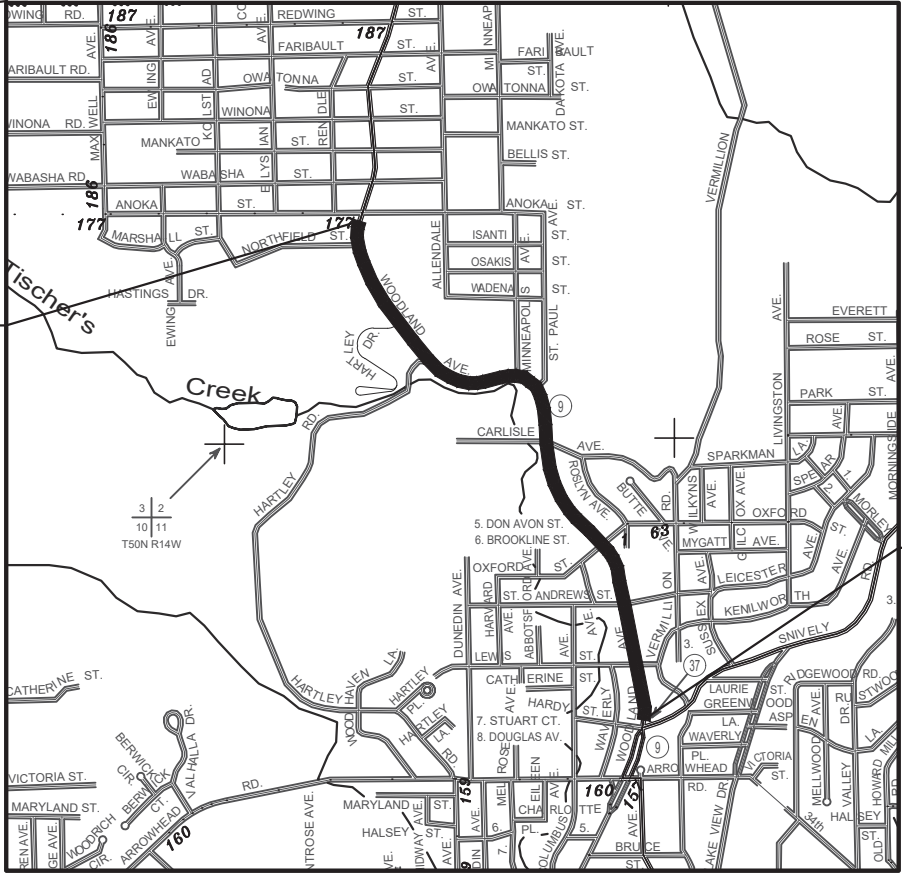

ST. LOUIS COUNTY
INDEX MAP

PREVIOUS PLANS	
2005	S.P. 69-609-35 C.P. 8267
1980	S.P. 69-609-06 CITY JOB NO. 7413

PLAN REVISIONS		
DATE	SHEET NO.	APPROVED BY

CP 0009-565027
SP 069-609-050

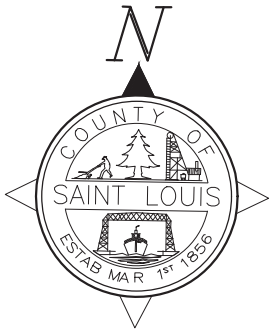

BEGIN SP 069-609-050
STA 7+95

MINN. PROJ. NO. STPF XXXX

GOVERNING SPECIFICATIONS
THE 2020 EDITION OF THE MINNESOTA DEPARTMENT OF TRANSPORTATION
"STANDARD SPECIFICATIONS FOR CONSTRUCTION"

AVAILABLE AT: <http://www.dot.state.mn.us/pre-letting/spec/index.html>

INDEX OF SHEETS

1 TITLE SHEET

- THIS PLAN CONTAINS XX SHEETS -

DESIGN DESIGNATION

R VALUE	10	$\Sigma N1820$	=	351,358
ADT (Current Year)	2023	=	11116	
ADT (Future Year)	2043	=	12227	
D (Directional Distr.)		=	50/50%	
T (Heavy Commercial 3.6%)		=	437	
Proj. Soil Factor		=	130 (R=10)	
Design Loading	=	9 TON		
Traffic Lanes	=	11.0'		
Center Turn Lane	=	12.0'		
Bike Lanes	=	7.0'		
Functional Class	=	MAJOR COLLECTOR		
Design Speed	=	30 MPH		

DESIGN SQUAD: J. PEARSON

I HEREBY CERTIFY THAT THIS PLAN WAS PREPARED BY ME OR UNDER
MY DIRECT SUPERVISION AND THAT I AM A DULY LICENSED PROFESSIONAL
ENGINEER UNDER THE LAWS OF THE STATE OF MINNESOTA.

PRINT NAME: ISSUED FOR REVIEW

SIGNATURE: _____

DATE: _____ LIC. NO.: 45397

APPROVED: _____ DATE: _____
ST. LOUIS COUNTY HIGHWAY ENGINEER

DISTRICT STATE AID ENGINEER: REVIEWED FOR
COMPLIANCE WITH STATE-AID AND FEDERAL RULES/POLICY

STATE AID ENGINEER: APPROVED FOR FEDERAL AND STATE AID FUNDING
DATE: _____

SHEET NO. ---- OF XX SHEETS