



RECEIVED

JAN 21 2015

CITY OF DULUTH
CITY CLERK'S OFFICE

City Clerk's Office

Room 318
411 West First Street
Duluth, Minnesota 55802-1189



218-730-5500
218-730-5923 Fax

APPLICATION

LICENSE	FEE
PERMANENT EXPANSION OF LICENSED PREMISES	\$146.00

LICENSEE BUSINESS NAME & ADDRESS:

BATHSKELLAR - SNIVELY LOUNGE
132 E SUPERIOR ST
DULUTH, MN 55802

TRADE NAME:

JUST TAKE ACTION INC

BUSINESS PHONE NO:

(218) 393-0970

EMAIL ADDRESS:

raymond@bathskellar.com

MANAGER'S NAME & ADDRESS

ROD RAYMOND
227 FAIRMONT
DULUTH, MN 55802

COMMENTS: INCLUDE AN EXPLANATION OF AREA TO BE EXPANDED ON ATTACHED FORM.

WE ARE EXPANDING THE BATHSKELLAR - UPSTAIRS IN
a portion (700 sq ft) of the old wasabi space

I HEREBY STATE THAT ALL INFORMATION HERE IS TRUE AND CORRECT AND THAT I SHALL COMPLY WITH ALL PROVISION OF THE ORDINANCES OF THE CITY OF DULUTH AND LAWS OF THE STATE OF MINNESOTA AND THEIR AMENDMENTS.

Signature of Applicant

1/20/15
Date

Date of Application: _____

License No. _____

Trade Name: JUST TAKE ACTION

DBA KANKELLA (Intively Lounge)

Address: 132 E. Superior St.

700 sq ft (Hotel lobby)

PERMANENT EXPANSION OF DESIGNATED SERVING AREA SITE PLAN

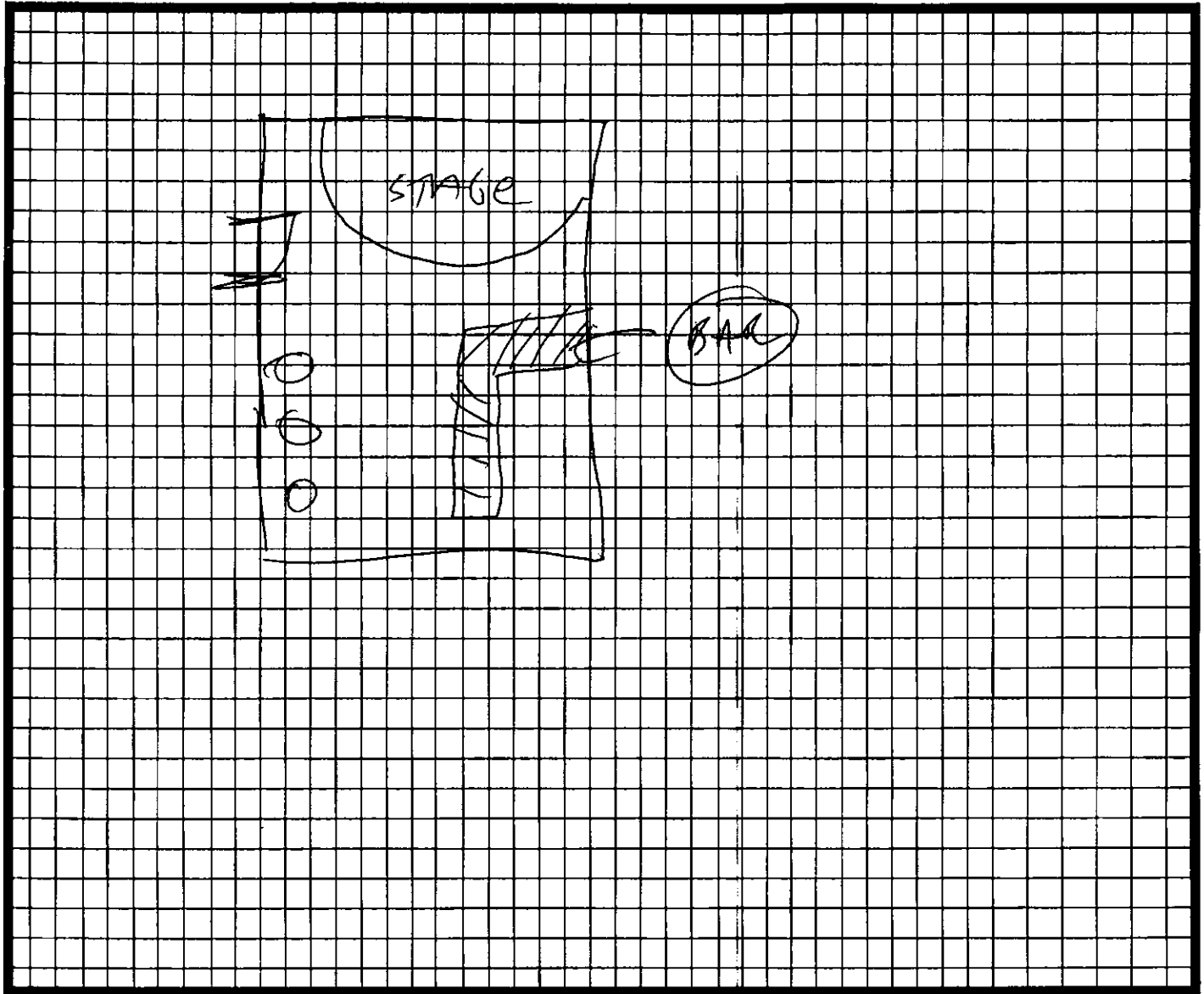

Signature of owner/authorized representative