

# MINNESOTA DEPARTMENT OF TRANSPORTATION DULUTH WORKS AND UTILITIES DIVISION

CONCRETE PAVEMENT REPAIRS (CPR)  
PAVING, CONCRETE SURFACING & LIGHTING

## 3RD AVE W

LOCATED ON: 3RD AVE W (MSAS 137) FROM SUPERIOR ST  
(MSAS 171) TO MICHIGAN ST (MSAS 145)  
IN THE CITY OF DULUTH

STATE AID PROJ. NO. 118-137-010

CITY JOB NO. 2254

GROSS LENGTH	130 FEET	0.024 MILES
BRIDGE LENGTH	0 FEET	0.000 MILES
EXCEPTIONS	0 FEET	0.000 MILES
NET LENGTH	130 FEET	0.024 MILES

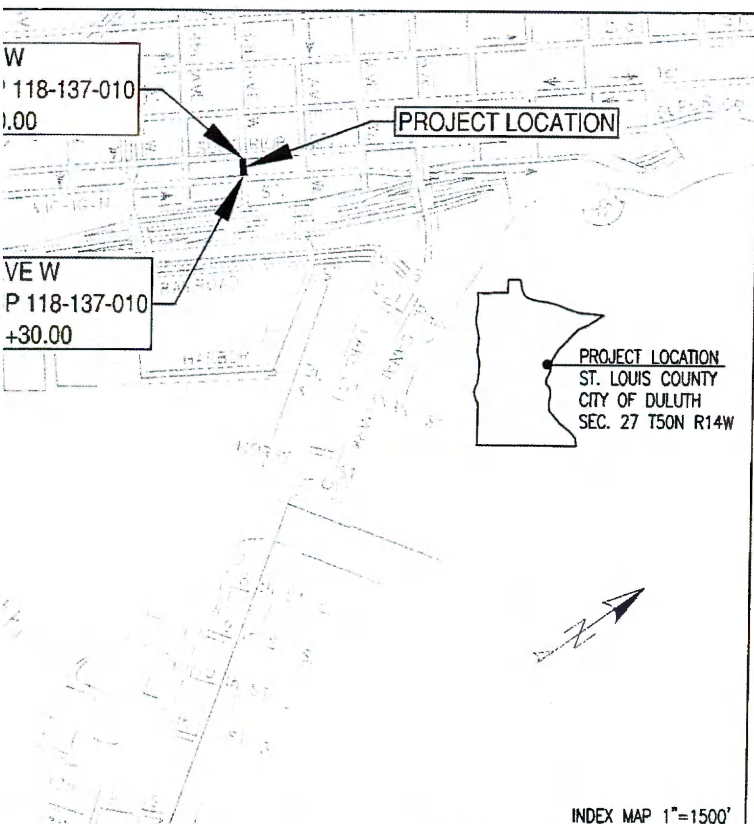

CAUTION 1996 (STCTM\_96).  
1409 BENCHMARK ELEV = 619.56  
APPROX. S'LY RIGHT OF WAY

**WARNING**  
LOCATION OF UNDERGROUND UTILITIES  
TO BE VERIFIED BY CONTRACTOR.  
CALL BEFORE DIGGING.  
GOPHER STATE ONE CALL  
1-800-252-1166  
REQUIRED BY LAW

MINN. PROJECT NO. NHPP 6925(309)

### GOVERNING SPECIFICATIONS

THE 2020 EDITION OF THE MINNESOTA DEPARTMENT OF TRANSPORTATION  
"STANDARD SPECIFICATIONS FOR CONSTRUCTION" SHALL GOVERN. AVAILABLE AT:  
<http://www.dot.state.mn.us/pre-letting/spec/index.html>

THE 2019 EDITION OF THE CITY OF DULUTH PUBLIC WORKS AND UTILITIES DEPARTMENT  
CONSTRUCTION STANDARDS AND SUPPLEMENTS OR ADDENDUMS SHALL APPLY.  
AVAILABLE AT: <http://www.duluthmn.gov/engineering/standard-construction-specifications/>

THE SUBSURFACE UTILITY INFORMATION IN THIS PLAN IS UTILITY LEVEL D.  
THIS QUALITY LEVEL WAS DETERMINED ACCORDING TO THE GUIDELINES OF C/ASCE 38-22,  
ENTITLED "STANDARD GUIDELINE FOR INVESTIGATING DOCUMENTING EXISTING UTILITIES".

### INDEX

SHEET NO.	DESCRIPTION
1	TITLE SHEET
2	GENERAL LAYOUT
3	STATEMENT OF ESTIMATED QUANTITIES
4	ESTIMATED QTY NOTES & STD PLTS-PLANS
5-8	QUANTITY CHARTS
9-11	TYPICAL SECTIONS & EXISTING DETAILS
12-21	DETAILS
22-26	TRAFFIC CONTROL
27-30	EROSION CONTROL
31-34	3RD AVE W PLAN SHEETS
35	GARFIELD AVE PLAN SHEET
THIS PLAN CONTAINS 35 SHEETS	

### DESIGN DESIGNATION

PROJECT	3RD AVE W	GARFIELD AVE
PRESENT ADT (YEAR)	1651 (2023)	5300 (2018)
PROJECTED ADT (YEAR)	2842 (2045)	4250 (2045)
FUNCTIONAL CLASSIFICATION	MINOR COLLECTOR	MAJOR COLLECTOR
NO. OF TRAFFIC LANES	2	2
TRAFFIC LANES (FEET)	11.0 FT	11.0 FT
NO. OF PARKING LANES	0	0
SHOULDER WIDTH (FEET)	NA	0-10 FT
STRUCT. DESIGN STRENGTH (TONS)	9 TON	9 TON
R VALUE	12	NA
ESALS	595,000	NA
DESIGN SPEED (MPH)	30 MPH	30 MPH
HEIGHT OF EYE (FEET)	3.5 FT	3.5 FT
HEIGHT OF OBJECT (FEET)	2.0 FT	2.0 FT

I HEREBY CERTIFY THAT THIS PLAN WAS PREPARED BY ME OR  
UNDER MY DIRECT SUPERVISION AND THAT I AM A DULY LICENSED  
PROFESSIONAL ENGINEER UNDER THE LAWS OF THE STATE OF MINNESOTA.

CYNTHIA J VOIGT

PROJECT ENGINEER (TYPED OR PRINTED NAME)

*Cynthia J Voigt* 5-23-25 24082  
PROJECT ENGINEER DATE REG. NO.

CITY APPROVALS:

*Chelusa* 5/23/25  
APPROVED CHIEF ENGINEER OF TRANSPORTATION DATE

*Howard Smith* 5-23-2025  
APPROVED CHIEF ENGINEER OF UTILITIES DATE

*Cynthia J Voigt* 5-23-25  
APPROVED CITY ENGINEER DATE

STATE AID APPROVALS:

Derek Fredrickson Digitally signed by Derek Fredrickson  
Date: 2025.06.11 07:52:30 -05'00'

DISTRICT STATE AID ENGINEER: REVIEWED FOR COMPLIANCE  
WITH STATE AND/OR FEDERAL AID RULES/POLICY DATE

Angela Murphy Digitally signed by Angela Murphy  
Date: 2025.06.17 09:27:32 -05'00'

APPROVED FOR STATE AND/OR FEDERAL AID FUNDING: STATE AID ENGINEER DATE

DULUTH PROJECT NOS. 1823 & 2254

STATE AID PROJECT NOS. SP 118-080-065 & SP 118-137-010

SHEET NO. 1 OF 35