

MINNESOTA DEPARTMENT OF TRANSPORTATION SAINT LOUIS COUNTY

CONSTRUCTION PLAN FOR: GRADING, BITUMINOUS SURFACING, SIDEWALK, AND ADA PEDESTRIAN IMPROVEMENTS

LOCATED ON BOUNDARY AVENUE BETWEEN ANCHOR STREET AND ORCHARD STREET
FROM A POINT THAT IS 408.2' SOUTH OF THE WEST QUARTER CORNER OF SECTION 11, T49N, R15W TO THE WEST QUARTER CORNER OF SECTION 11, T49N, R15W

STATE PROJ. NO. 069-614-022

COUNTY PROJ. NO. 0014-376295

GROSS LENGTH 944.50 FEET 0.179 MILES

BRIDGES-LENGTH N/A FEET N/A MILES

EXCEPTIONS-LENGTH N/A FEET N/A MILES

NET LENGTH 944.50 FEET 0.179 MILES

WARNING
LOCATION OF UNDERGROUND UTILITIES
TO BE VERIFIED BY CONTRACTOR.
CALL BEFORE DIGGING.
GOPHER STATE ONE CALL
811 OR 1-800-252-1166
REQUIRED BY LAW

PLAN SYMBOLS	
SECTION SUBDIVISION LINE	---
EXISTING R/W	----
NEW R/W	----
TEMP EASE	----
RAILROAD R/W	----
UNSURFACED RD. OR SHLD.	----
EDGE OF LAKE	----
SWAMP BOUNDARY	----
MISCELLANEOUS BOUNDARY	----
CORPORATE OR CITY LIMITS	////
PROPERTY LINE	----
RECREATIONAL TRAIL	----
ALIGNMENT STATIONS	110+ 112+ ----- -----
ALIGNMENT POINTS	----- ----- -----
RIVER OR CREEK	~~~~~
DRAINAGE DITCH	----- ----- -----
BRIDGE	----- ----- -----
RAILROAD (SINGLE TRACK)	----- ----- -----
RR CROSSING PAVEMENT MARKING	----- ----- -----
RR CROSSING GATE	----- ----- -----
RR CROSSBUCK SIGN	----- ----- -----
RR CROSSBUCK SIGN W/LIGHTS	----- ----- -----
BARBED WIRE FENCE	----- ----- -----
CHAIN LINK FENCE	----- ----- -----
WOVEN WIRE, COMBINATION WOVEN AND BARB	----- ----- -----
WOOD FENCE	----- ----- -----
BILLBOARD	----- ----- -----
RETAINING WALL	----- ----- -----
GUARDRAIL (CABLE)	----- ----- -----
GUARDRAIL (PLATE BEAM)	----- ----- -----
DRAIN TILE	----- ----- -----
CULVERT	----- ----- -----
CULVERT WITH APRONS	----- ----- -----
WOODS OR BRUSH, NURSERY	----- ----- -----
DECIDUOUS TREES	----- ----- -----
CONIFER (EVERGREEN) TREES	----- ----- -----
HEDGE	----- ----- -----
BUSH OR SHRUB	----- ----- -----
STUMP	----- ----- -----
SWAMP OR MARSH	----- ----- -----
MONUMENT (CI, ACT, ACP, BCP, ...)	----- ----- -----
CONCRETE OR STONE MONUMENT	----- ----- -----
IRON PIPE	----- ----- -----
IRON PIN OR REBAR	----- ----- -----
IRON PIN WITH BRASS DISK	----- ----- -----
NAIL, PK NAIL, SPIKE, SFP, T-BAR, ...	----- ----- -----
VERTICAL CONTROL	----- ----- -----
HORIZONTAL CONTROL	----- ----- -----
POWER POLE	----- ----- -----
LIGHT POLE	----- ----- -----
LIGHT AND TELEPHONE POLE	----- ----- -----
LIGHT, TELEPHONE AND POWER POLE	----- ----- -----
GUY POLE	----- ----- -----
POLE ANCHOR	----- ----- -----
TELEPHONE POLE	----- ----- -----
TELEPHONE AND POWER POLE	----- ----- -----
UNDERGROUND CABLE PEDESTAL	----- ----- -----
TELEPHONE MANHOLE (VAULT)	----- ----- -----
ELECTRIC CABLE IN CONDUIT	----- ----- -----
TELEPHONE CABLE IN CONDUIT	----- ----- -----
BURIED ELECTRIC CABLE	----- ----- -----
BURIED TELEPHONE CABLE	----- ----- -----
GAS LINE	----- ----- -----
WATER LINE	----- ----- -----
VALVE	----- ----- -----
FIRE HYDRANT	----- ----- -----
WATER MANHOLE	----- ----- -----
WELL	----- ----- -----
LAWN SPRINKLER HEAD	----- ----- -----
MANHOLE	----- ----- -----
CATCH BASIN	----- ----- -----
SEPTIC TANK	----- ----- -----
FORCE MAIN LIFT STA.	----- ----- -----
SEWER LINE	----- ----- -----
PERMANENT BARRICADE	----- ----- -----
TRAFFIC SIGNAL LIGHT	----- ----- -----
HAND HOLE	----- ----- -----
ENTRANCE	----- ----- -----
BUILDING	----- ----- -----
SATELLITE DISH	----- ----- -----
STEEL TOWER	----- ----- -----
FLAG POLE	----- ----- -----

END PROJECT: S.P. 069-614-022
STA. 210+25.10

BEGIN PROJECT: S.P. 069-614-022
STA. 200+80.60

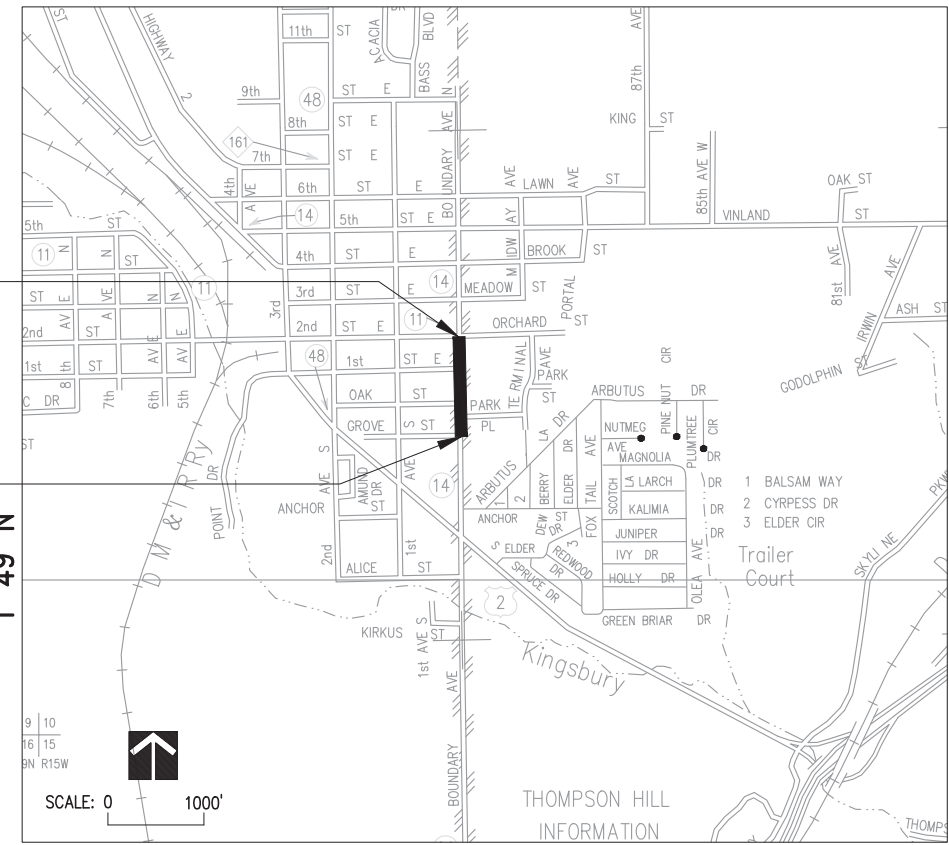
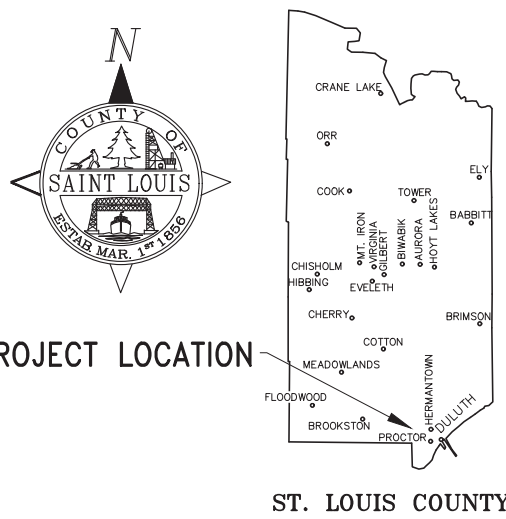

SUBSURFACE UTILITY NOTE:
THE SUBSURFACE UTILITY INFORMATION IN THIS PLAN IS UTILITY QUALITY LEVEL D. THIS UTILITY QUALITY LEVEL WAS DETERMINED ACCORDING TO THE GUIDELINES OF CI/ASCE 38-02, ENTITLED "STANDARD GUIDELINES FOR THE COLLECTION AND DEPICTION OF EXISTING SUBSURFACE UTILITY DATA".

SCALES		
PLAN	20 ft.	
PROFILE	20 ft.	5 ft.
	HORIZ.	VERT.



PLAN REVISIONS		
DATE	SHEET NO.	APPROVED BY

S.P. 069-614-022 C.P. 0014-376295

MN. PROJECT No. _____

GOVERNING SPECIFICATIONS
THE 2020 EDITION OF THE MINNESOTA DEPARTMENT OF TRANSPORTATION "STANDARD SPECIFICATIONS FOR CONSTRUCTION" SHALL GOVERN.
ALL TRAFFIC CONTROL DEVICES AND SIGNING SHALL CONFORM TO THE MN MUTCD, INCLUDING THE FIELD MANUAL DATED "LATEST EDITION" AVAILABLE AT: <https://www.dot.state.mn.us/trafficeng/publ/fieldmanual/fieldmanual.pdf>

INDEX OF SHEETS	
SHEET NO.	DESCRIPTION
1	TITLE SHEET AND INDEX MAP
2	NOTES & STATEMENT OF ESTIMATED QUANTITIES
3-4	TABULATIONS
5-6	TYPICAL SECTIONS
7-21	CONSTRUCTION DETAILS
22	STORM PROFILES
23	REMOVALS AND EROSION CONTROL PLAN
24	CONSTRUCTION PLAN
25	PARK PLACE PLAN & PROFILE
26-27	TRAFFIC CONTROL PLAN
28-35	CROSS SECTIONS

90% SUBMITTAL
NOT FOR CONSTRUCTION
11/9/2021

- THIS PLAN CONTAINS 35 SHEETS -

DESIGN DESIGNATION	
R VALUE =	≤N18 20 =
ADT (Current Year) 2021	= 2840
ADT (Future Year) 2041	= 3124
D (Directional Distr.)	= 50-50%
T (Heavy Commercial)	=
Proj. Soil Factor	=
Shoulder Width	= 8'
Design Loading	= 10 TON
Design Speed	30 MPH
Based on STOPPING Sight Distance	
Height Of Eye 3.5 ft.	Height of object 2.0 ft.
Design Speed not achieved at:	
STA. _____ TO STA. _____ MPH _____	
STA. _____ TO STA. _____ MPH _____	
Classification	URBAN MAJOR COLLECTOR
Traffic Lanes	2 @ 12' Each
Parking Lanes	2 @ 10' Each

DESIGNERS M. GOPLIN, P. BARDEN

I hereby certify that this plan was prepared by me or under my direct supervision and that I am a duly Licensed Professional Engineer under the laws of the State of Minnesota.

Print Name: MEGAN GOPLIN

Signature: _____

Date: xx/xx/xxxx Reg. #: 53018

Approved: St. Louis County Highway Engineer _____ Date: _____

District State Aid Engineer: Reviewed for compliance with State Aid rules/policy _____ Date: _____

State Aid Engineer: Approved for Federal Aid Funding _____ Date: _____

SHEET 1 OF 35 SHEETS