

LEGAL DESCRIPTION OF PROPOSED RIGHT OF WAY VACATION

All of Oscar Street and all that part of Rudolph Street lying East of the East line of Blackman Avenue (Helmer Street per plat) as dedicated on the plat of SWENSON'S DIVISION OF DULUTH, according to the recorded plat thereof, St. Louis County, Minnesota.

AND

All that part of the Alley lying adjacent to and abutting Block 1 lying East of the East line of Blackman Avenue (Helmer Street per plat) as dedicated on the plat of SWENSON'S DIVISION OF DULUTH, according to the recorded plat thereof, St. Louis County, Minnesota.

AND

All that part of the Alley lying adjacent to and abutting Block 2 lying East of the East line of Blackman Avenue (Helmer Street per plat) as dedicated on the plat of SWENSON'S DIVISION OF DULUTH, according to the recorded plat thereof, St. Louis County, Minnesota.

Said proposed right of way area to be vacated contains 59,426 square feet or 1.36 acres

LEGAL DESCRIPTION OF PROPOSED BUILDING LINE EASEMENT VACATION

All of the building line easement lying within Block 1 as dedicated on the plat of SWENSON'S DIVISION OF DULUTH, according to the recorded plat thereof, St. Louis County, Minnesota.

AND

All of the building line easement lying within Block 2 as dedicated on the plat of SWENSON'S DIVISION OF DULUTH, according to the recorded plat thereof, St. Louis County, Minnesota.

Said proposed building line easement area to be vacated contains 23,685 square feet or 0.54 acres

SURVEYOR'S NOTES

1. THIS SURVEY HAS BEEN PREPARED WITHOUT BENEFIT OF A TITLE COMMITMENT OR TITLE OPINION. A TITLE SEARCH FOR RECORDED OR UNRECORDED EASEMENTS WHICH MAY BENEFIT OR ENCUMBER THIS PROPERTY HAS NOT BEEN COMPLETED BY ALTA LAND SURVEY COMPANY. THE SURVEYOR ASSUMES NO RESPONSIBILITY FOR SHOWING THE LOCATION OF RECORDED OR UNRECORDED EASEMENTS OR OTHER ENCUMBRANCES NOT PROVIDED TO THE SURVEYOR AS OF THE DATE OF THE SURVEY.
2. THIS IS NOT A BOUNDARY SURVEY.

Approved by the City Engineer of the  
City of Duluth, MN this 18 day  
of MAR 2022

By

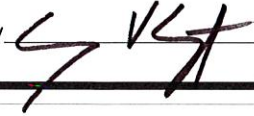

I hereby certify that this survey, plan, or report was prepared by me or under my direct supervision and that I am a duly Licensed Land Surveyor under the laws of the State of Minnesota.

  
David R. Evanson  
DATE: 09-09-2021 MN License #49505

**VACATION EXHIBIT**

CLIENT: NCE

REVISIONS:

ADDRESS: XXX SOUTH BLACKMAN AVENUE  
DULUTH, MN 55811

DATE: 09-09-2021

JOB NO: 21-105

SHEET 1 OF 2

 **ALTA**  
LAND SURVEY COMPANY

PHONE: 218-727-5211  
LICENSED IN MN & WI  
WWW.ALTLANDSURVEYDULUTH.COM

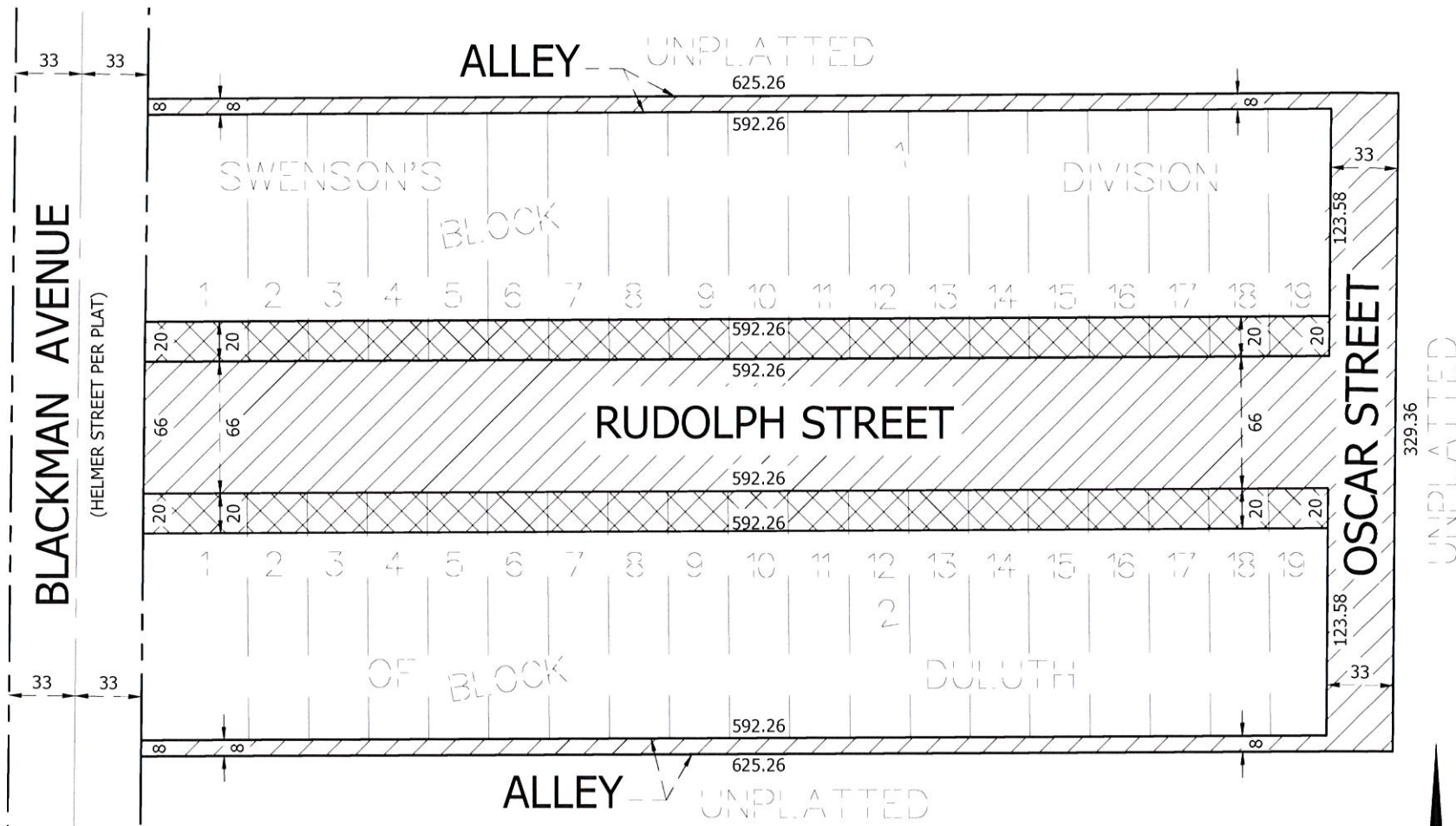

## LEGEND

	EXISTING PLAT LINE
	CENTER LINE
	RIGHT OF WAY LINE
	VACATION OF RIGHT OF WAY
	VACATION OF BUILDING LINE EASEMENT



## VACATION EXHIBIT

CLIENT: NCE  
ADDRESS: XXX SOUTH BLACKMAN AVENUE  
DULUTH, MN 55811  
DATE: 09-09-2021

REVISIONS:

JOB NO: 21-105 SHEET 2 OF 2

**ALTA**  
LAND SURVEY COMPANY

PHONE: 218-727-5211  
LICENSED IN MN & WI  
WWW.ALTLANDSURVEYDULUTH.COM