

K:\Projects\410 CSAP\CSAP 54\CP 0054 401138\Drawings\410 Sheets\CP 0054 401138 Title sheet.dwg 80 CSAP\CSAP 54\CP 0054 401138\400 Design\410 Sheets\CP 0054 401138

PLAN SYMBOLS	
SECTION SUBDIVISION LINE	---
EXISTING R/W	---
NEW R/W	---
TEMP EASE	---
RAILROAD R/W	---
ROAD SHOULDER	---
EDGE OF LAKE	---
SWAMP BOUNDARY	---
W/SCHELANDUS BOUNDARY	---
CORPORATE OR CITY LIMITS	---
PROPERTY LINE	---
RECREATIONAL TRAIL	---
ROAD ALIGNMENT	---
ALIGNMENT POINTS	---
RIVER OR CREEK	---
DRAINAGE DITCH	---
BRIDGE	---
RAILROAD (SINGLE TRACK)	---
RR CROSSING PAVEMENT MARKING	---
RR CROSSING GATE	---
RR CROSSBUCK SIGN	---
RR CROSSBUCK SIGN W/HEIGHTS	---
BARBED WIRE FENCE	---
CHAIN LINK FENCE	---
WOVEN WIRE, COMBINATION WOVEN AND BARB	---
WOOD FENCE	---
BILLBOARD	---
RETAINING WALL	---
GUARDRAIL (CABLE)	---
GUARDRAIL (PLATE BEAM)	---
DRAIN TILE	---
CULVERT	---
CULVERT WITH APRONS	---
TREELINE OR BRUSH-LINE	---
DECIDUOUS TREES	---
CONIFER (EVERGREEN) TREES	---
HEDGE	---
BUSH OR SHRUB	---
SWAMP OR MARSH	---
MONUMENT (C/O ACT, ACP, BOP, ...)	---
CONCRETE OR STONE MONUMENT	---
IRON PIPE, PIN OR REBAR	---
IRON PIN WITH BRASS DISK	---
NAIL, PK NAIL, SPOKE, STP, T-BAR, ...	---
VERTICAL CONTROL	---
HORIZONTAL CONTROL	---
POWER POLE	---
LOG POLE	---
LIGHT AND TELEPHONE POLE	---
LIGHT, TELEPHONE AND POWER POLE	---
GUY POLE	---
POLE ANCHOR	---
TELEPHONE POLE	---
TELEPHONE AND POWER POLE	---
UNDERGROUND UTILITY PEDESTAL	---
TELEPHONE MAN-POLE (VAULT)	---
ELECTRIC CABLE IN CONDUIT	---
TELEPHONE CABLE IN CONDUIT	---
BURIED ELECTRIC CABLE	---
BURIED TELEPHONE CABLE	---
GAS LINE	---
WATER LINE	---
VALVE	---
FIRE HYDRANT	---
WATER MAN-POLE	---
WELL	---
LAWN SPRINKLER HEAD	---
MAN-POLE	---
CATCH BASIN	---
SEPTIC TANK	---
FORCED MAN-POLE STA.	---
SEWER LINE	---
PERMANENT BARRICADE	---
TRAFFIC SIGNAL LIGHT	---
HAND HOLE	---
ENTRANCE	---
BUILDING	---
SATELLITE DISH	---
STEEL TOWER	---
FLAG POLE	---
SIGN	---
TYPE A BARRICADE	---
CHANNEL FLOW DEVICE	---
TYPE A WARNING LIGHT	---

MINNESOTA DEPARTMENT OF TRANSPORTATION SAINT LOUIS COUNTY

CONSTRUCTION PLAN FOR: MILL BITUMINOUS SURFACE, ADA PEDESTRIAN IMPROVEMENTS, STORM SEWER REPAIR,
CONCRETE CURB & GUTTER, CONCRETE SIDEWALK AND PLANT MIXED BITUMINOUS SURFACE

LOCATED ON CSAH 54 (PIEDMONT AVE)
BETWEEN A POINT APPROX. 130' SOUTHEAST AND A POINT APPROX. 85' NORTHWEST OF
OF CSAH 91 (HAINES RD) MSAS 208 (CHAMBERSBURG AVE)

FROM APPROXIMATELY 101' EAST AND 1,174' NORTH OF THE TO APPROXIMATELY 1,392' WEST AND 1,127' NORTH OF THE
W 1/4 CORNER OF SEC. 30, T50N, R14W. SW CORNER OF SEC. 29, T50N, R14W.

STATE PROJ. NO. 069-654-006

GROSS LENGTH	4,775.00	FEET	0.904	MILES
BRIDGES-LENGTH	0.00	FEET	0.000	MILES
EXCEPTIONS-LENGTH	0.00	FEET	0.000	MILES
NET LENGTH	4,775.00	FEET	0.904	MILES

GENERAL LAYOUT

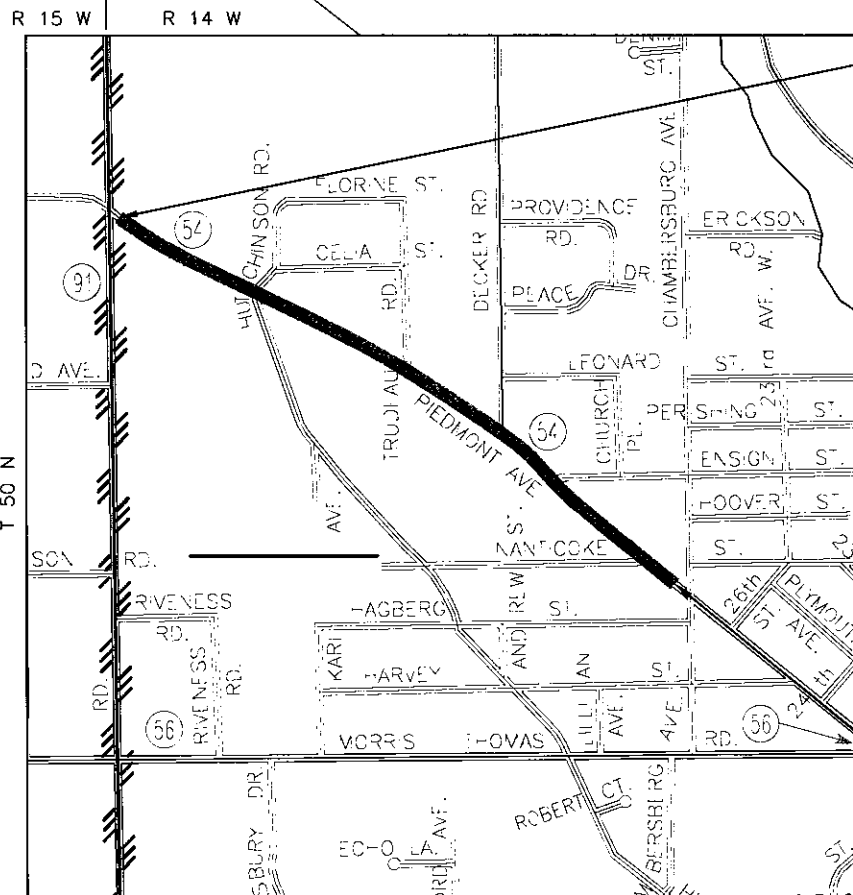

BEGIN SP 069-654-006
STA. 1+30

END SP 069-654-006
STA. 49+05



ST. LOUIS COUNTY
INDEX MAP

SCALE

INDEX MAP 0 0.25 MILES

MINN. PROJ. NO. XXXX

GOVERNING SPECIFICATIONS

THE 2020 EDITION OF THE MINNESOTA DEPARTMENT OF TRANSPORTATION
"STANDARD SPECIFICATIONS FOR CONSTRUCTION" SHALL GOVERN.
AVAILABLE AT: <http://www.dot.state.mn.us/pre-letting/spec/index.htm>

ALL TRAFFIC CONTROL SIGNING AND DEVICES SHALL CONFORM TO AND BE PLACED
IN ACCORDANCE WITH THE MINNESOTA "MANUAL ON UNIFORM TRAFFIC CONTROL
DEVICES" (MMUTCD) INCLUDING PART VI, THE CURRENT FIELD MANUAL, THE
MINNESOTA STANDARD SIGNS MANUAL PARTS I, II, III, AND APPROPRIATE MATERIAL
SPECIFICATIONS.

THE SUBSURFACE UTILITY INFORMATION IN THIS PLAN IS UTILITY QUALITY LEVEL D.
THE QUALITY LEVEL WAS DETERMINED ACCORDING TO THE GUIDELINES OF C/ASCE
38-02 ENTITLED "STANDARD GUIDELINES FOR THE COLLECTION AND DEPICTION OF
EXISTING SUBSURFACE UTILITY DATA."

INDEX OF SHEETS

SHEET NO.	DESCRIPTION
1	TITLE SHEET AND INDEX MAP
2	STATEMENT OF ESTIMATED QUANTITIES
3-5	TYPICAL SECTIONS
6-9	QUANTITY TABULATIONS
10-22	RUMBLE STRIP DETAILS
23-28	REMOVAL PLAN VIEWS
29-34	CONSTRUCTION PLAN VIEWS
35	STORM SEWER PROFILE
36	WALL REMOVAL CROSS SECTIONS
37-38	TRAFFIC CONTROL PLAN
39-44	PAVEMENT MARKING PLAN

THIS PLAN CONTAINS 44 SHEETS

DESIGN DESIGNATION - 8820.9946 URBAN; RECONDITIONING
STA. 1+30 TO STA. 40+50 & STA. 46+75 TO STA. 49+05

DESIGN DESIGNATION - 8820.9941 URBAN; NEW OR RECONSTRUCTION
STA. 40+50 TO STA. 46+75

R VALUE	30	=	$\Sigma N18_{20}$	=	550,754
ADT (CURRENT YEAR)	2023	=	6,014		
ADT (FUTURE YEAR)	2043	=	6,615		
D (DIRECTIONAL DISTR.)		=	50/50%		
T (HEAVY COMMERCIAL 3.6%)		=	236		
PROJ. SOIL FACTOR		=	75		
DESIGN LOADING		=	9 TON		
TRAFFIC LANES		=	(2) 11.0'		
PARKING LANE WIDTH		=	(2) 11.0'		
CURB TO CURB WIDTH		=	44.0'		
FUNCTIONAL CLASS		=	MINOR ARTERIAL		
DESIGN SPEED		=	30 mph		
BASED ON STOPPING SIGHT DISTANCE					
3.5' HEIGHT OF EYE AND 2' HEIGHT OF OBJECT					

DESIGNERS SOUTH DESIGN (AL)

I HEREBY CERTIFY THAT THIS PLAN WAS PREPARED BY ME OR UNDER
MY DIRECT SUPERVISION AND THAT I AM A DULY LICENSED PROFESSIONAL
ENGINEER UNDER THE LAWS OF THE STATE OF MINNESOTA.

PRINT NAME: STEPHEN E. KRASAWAY

SIGNATURE:

DATE: LIC. NO. 45397

APPROVED ST. LOUIS COUNTY HIGHWAY ENGINEER DATE

DISTRICT STATE AID ENGINEER: REVIEWED FOR COMPLIANCE WITH STATE AID RULES AND POLICIES DATE

STATE AID ENGINEER: APPROVED FOR FEDERAL AND STATE AID FUNDING DATE

SP 069-654-006

CP 0054-401138

SHEET NO. 1 OF 44 SHEETS