

**FIRST AMENDMENT TO
INVASIVE SPECIES CONTROL
SERVICES AND LICENSE AGREEMENT
BETWEEN CITY OF DULUTH AND
COMMUNITY ACTION DULUTH**

The Invasive Species Control Services and License Agreement #23443 dated April 20, 2018 (the "License Agreement") between the City of Duluth ("City") and Community Action Duluth ("CAD") (hereinafter collectively referred to as the "Parties") is amended as set forth below. Capitalized terms used in this First Amendment to Invasive Species Control Services and License Agreement (this "First Amendment"), but not defined herein, shall have the same meaning ascribed to them as in the License Agreement.

WHEREAS, the Parties wish to amend the License Agreement to: (a) include additional real estate to the Hartley Park Property and (b) extend the Term.

NOW, THEREFORE, in consideration of the mutual benefits contained herein, the Parties agree to amend the License Agreement as follows:

- A. Exhibit A-1 is amended and completely replaced with the attached Amended Exhibit A-1.
- B. Exhibit A-2 is amended and completely replaced with the attached Amended Exhibit A-2.
- C. Section II is amended and completely replaced with the following Section II:

II. TERM OF THE AGREEMENT. Notwithstanding the date of execution of this Agreement, the term of this Agreement shall commence on or about April 1, 2018, and shall continue through March 31, 2020, unless earlier terminated (the "Term").

C. Except as specifically amended pursuant to this First Amendment, the License Agreement remains in full force and effect. In the event of a conflict between the provisions of this First Amendment and the License Agreement, the provisions of the First Amendment shall govern.

[Remainder of this page is intentionally left blank.]

IN WITNESS WHEREOF, the Parties have hereunto set their hands the day and date first shown below.

CITY OF DULUTH, MINNESOTA

COMMUNITY ACTION DULUTH

By: _____
Mayor

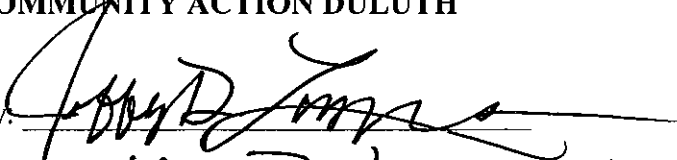
By: 
Its: Jeffrey R. Longenecker

ATTEST:

City Clerk

Title: Exec. Dir.
Dated: 9-10-19

Dated: _____

COUNTERSIGNED:

City Auditor

APPROVED AS TO FORM:

City Attorney

AMENDED EXHIBIT A-1

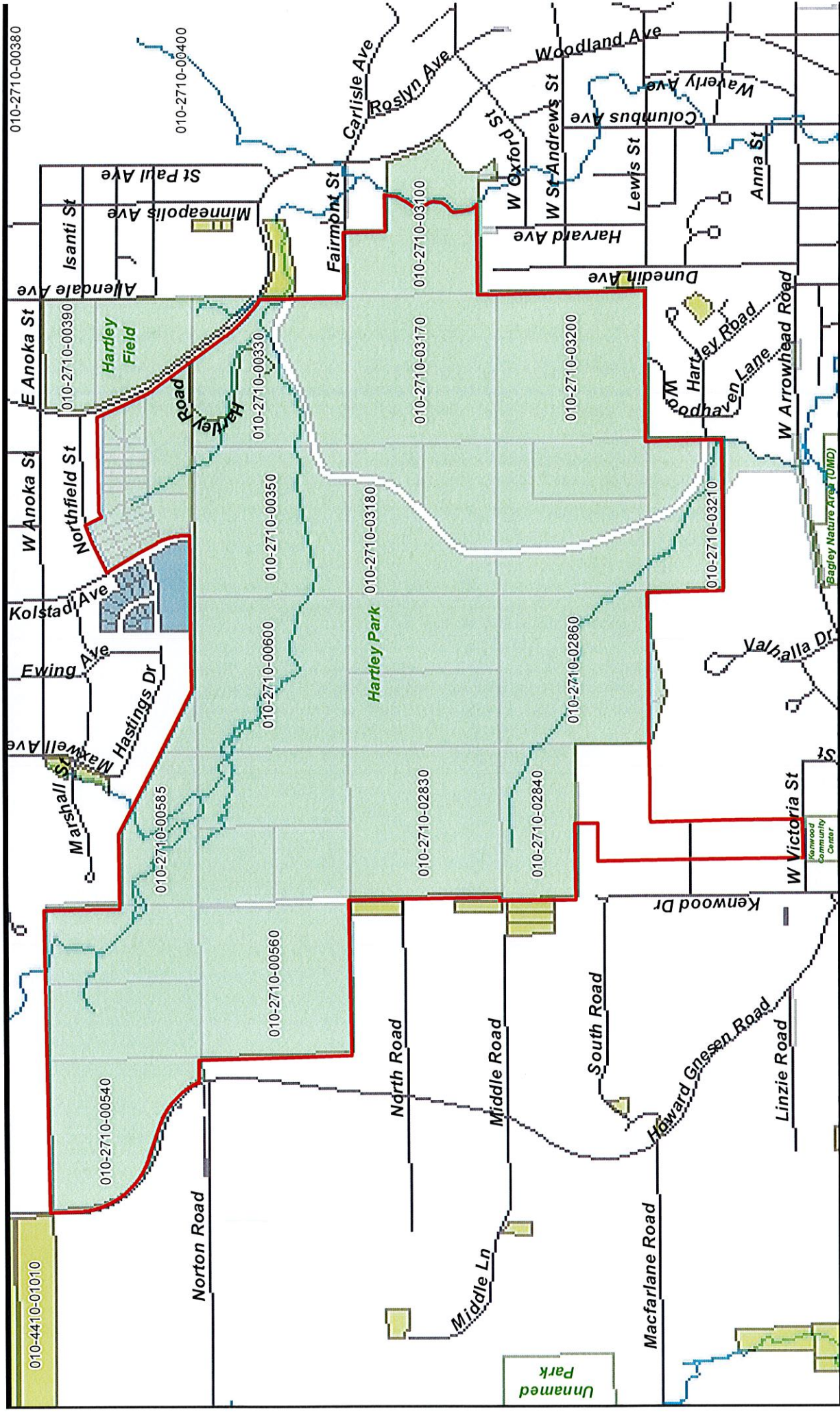

Printed Date: 8/26/2019

Community Action Duluth - Invasive Work Area

Ownership

- Area Name: Hartley
- City of Duluth
- ISD #709
- Regents of the U of M
- Tax Forfeit

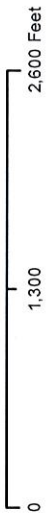

The City of Duluth has tried to ensure that the information contained in this map or electronic document is accurate. The City of Duluth makes no warranty or guarantee concerning the accuracy or reliability. This drawing/data is neither a legally recorded map nor a survey and is not intended to be used as one. The drawing/data is a compilation of records, information and data located in various City, County and State offices and other sources affecting the area shown and is to be used for reference purposes only. The City of Duluth shall not be liable for errors contained within this data provided or for any damages in connection with the use of this information contained within.

The City of Duluth requires that this map/data not be redistributed to any party in whole or in part, including any derivative works, without the express written permission of the City of Duluth, authorized by the City of Duluth GIS office.

AMENDED EXHIBIT A-2

HARTLEY PARK PROPERTY TAX PARCEL NUMBERS

010-4405-00200	010-2116-00190
010-4405-00210	010-2116-00200
010-2710-02820	010-2116-00210
010-2710-02825	010-2116-00220
010-2710-02830	010-2116-00230
010-2710-02840	010-2116-00240
010-2710-02860	010-2116-00250
010-2710-00525	010-2116-00260
010-2710-00526	010-2116-00270
010-2710-00560	010-2116-00280
010-2710-00572	010-2116-00290
010-2710-00585	010-2116-00300
010-2710-00590	010-2116-00310
010-2710-00595	010-2116-00320
010-2710-00596	010-2116-00330
010-2710-00600	010-2116-00340
010-2710-00350	010-2116-00350
010-2710-00330	010-2116-00480
010-2710-03170	010-2116-00490
010-2710-03200	010-2116-00500
010-2710-03185	010-2116-00510
010-2710-03180	010-2116-00520
010-2710-03195	010-2116-00530
010-2710-03190	010-2116-00540
010-2710-03210	010-2116-00550
010-2710-03245	010-2116-00560
010-2710-03100	010-2116-00570
	010-2116-00580
	010-2116-00590
	010-2116-00600
	010-2116-00610
	010-2116-00620
	010-2116-00630
	010-2116-00640
	010-2116-00650