

# MINNESOTA DEPARTMENT OF TRANSPORTATION

## CITY OF DULUTH

### DEPARTMENT OF PUBLIC WORKS AND UTILITIES

### ENGINEERING DIVISION

CONSTRUCTION PLAN FOR : MILL & OVERLAY, RECLAIMING, CURB & GUTTER, SIDEWALKS, ADA IMPROVEMENTS,  
 LOCATED ON: W. ANOKA ST., BRISTOL ST., CLOVER ST., E. 8TH ST., HIGHLAND ST., MAXWELL AVE.

#### GOVERNING SPECIFICATIONS

THE 2018 EDITION OF THE MINNESOTA DEPARTMENT OF TRANSPORTATION "STANDARD SPECIFICATIONS FOR CONSTRUCTION" SHALL GOVERN.

AVAILABLE AT:  
<http://www.dot.state.mn.us/pre-letting/spec/index.html>

THE 2017 EDITION OF THE CITY OF DULUTH PUBLIC WORKS AND UTILITIES DEPARTMENT CONSTRUCTION STANDARDS AND SUPPLEMENTS OR ADDENDUMS SHALL APPLY.

AVAILABLE AT:  
<http://www.duluthmn.gov/engineering/standard-construction-specifications/>

ALL TRAFFIC CONTROL DEVICES AND SIGNING SHALL CONFORM TO THE MN MUTCD, INCLUDING THE FIELD MANUAL DATED JANUARY 2014

AVAILABLE AT:  
<http://www.dot.state.mn.us/trafficeng/publ/fieldmanual/index.html>

THE SUBSURFACE UTILITY INFORMATION IN THIS PLAN IS UTILITY LEVEL D. THIS QUALITY LEVEL WAS DETERMINED ACCORDING TO THE GUIDELINES OF CI/ASCE 38-02, ENTITLED "STANDARD GUIDELINES FOR THE COLLECTION AND DEPICTION OF EXISTING SUBSURFACE UTILITY DATA".

#### INDEX

SHEET NO.	DESCRIPTION
1	TITLE
2	STATEMENT OF ESTIMATE QUANTITIES
3-6	TYPICAL SECTIONS
7	DETAILS
8-12	TABULATIONS
13-16	PAVEMENT MARKINGS
17-21	TRAFFIC CONTROL

THIS PLAN CONTAINS 21 SHEETS

CITY OF DULUTH PROJECT NO.	1690		
GROSS LENGTH	XX.XX	FEET	XX.XX MILES
W. ANOKA ST.	2943.6'	FEET	0.557 MILES
BRISTOL ST.	748.85	FEET	0.142 MILES
CLOVER ST.	XX.XX	FEET	XX.XX MILES
HIGHLAND ST.	XX.XX	FEET	XX.XX MILES
E. 8TH ST.	XX.XX	FEET	XX.XX MILES
MAXWELL ST.	2236.98	FEET	0.885 MILES
EXCEPTIONS-LENGTH	X	FEET	X MILES
NET LENGTH	XX	FEET	XX MILES

I HEREBY CERTIFY THAT THIS PLAN WAS PREPARED BY ME OR UNDER MY DIRECT SUPERVISION AND THAT I AM A DULY LICENSED PROFESSIONAL ENGINEER UNDER THE LAWS OF THE STATE OF MINNESOTA.

PRINT NAME: \_\_\_\_\_ LICENSE # \_\_\_\_\_

DATE: \_\_\_\_\_ SIGNATURE: \_\_\_\_\_

DESIGN TEAM P.LOOMIS, D.KRATOCHWILL, S.ANDERSON

#### CITY OF DULUTH APPROVALS

RECOMMENDED FOR APPROVAL \_\_\_\_\_ 20 \_\_\_\_\_  
 CHIEF ENGINEER OF TRANSPORTATION

RECOMMENDED FOR APPROVAL \_\_\_\_\_ 20 \_\_\_\_\_  
 CHIEF ENGINEER OF UTILITIES

RECOMMENDED FOR APPROVAL \_\_\_\_\_ 20 \_\_\_\_\_  
 CITY ENGINEER

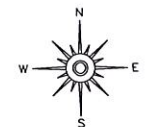
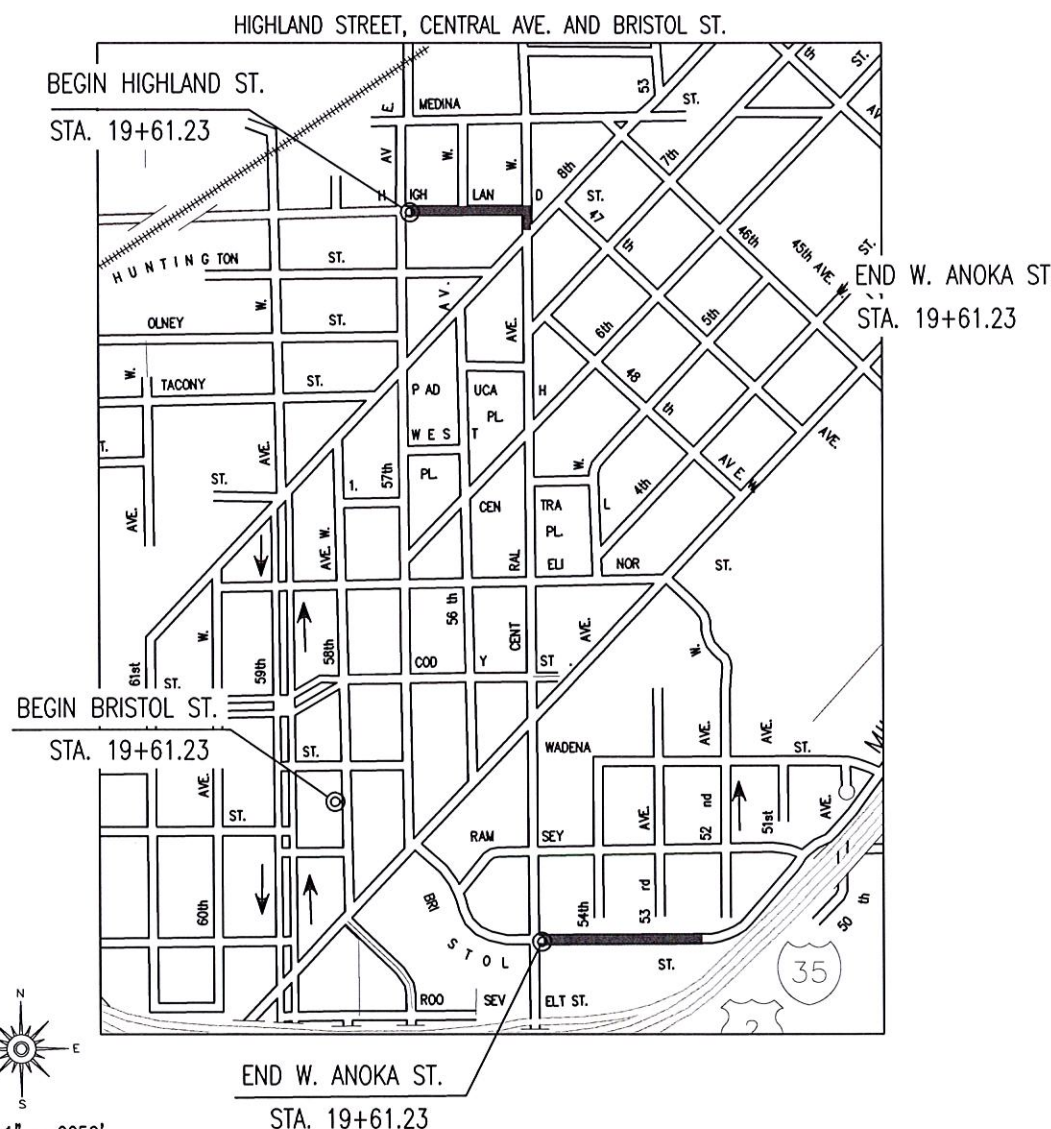
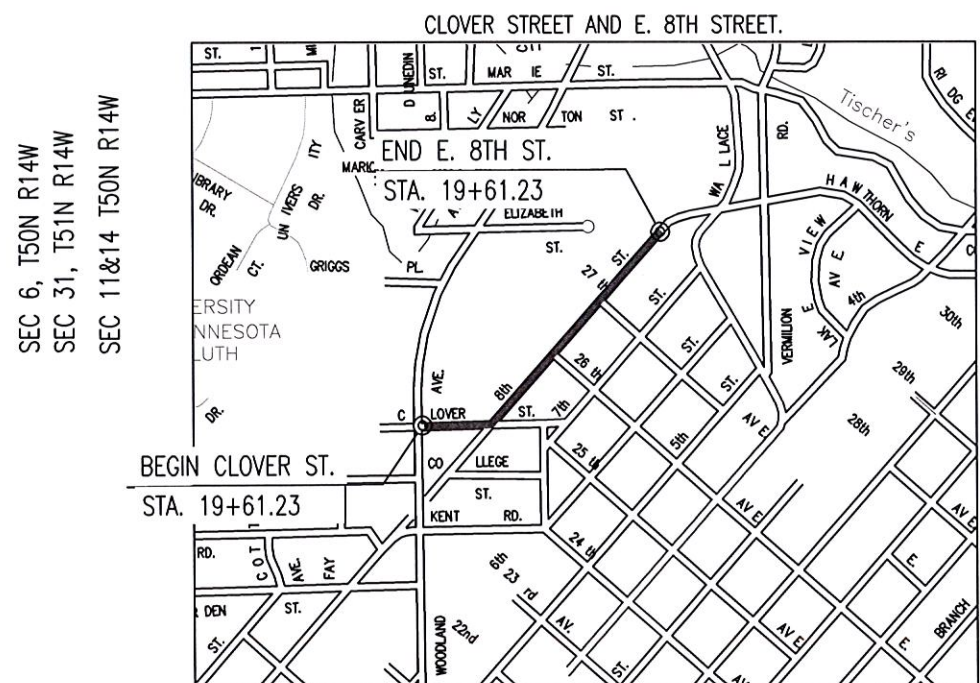
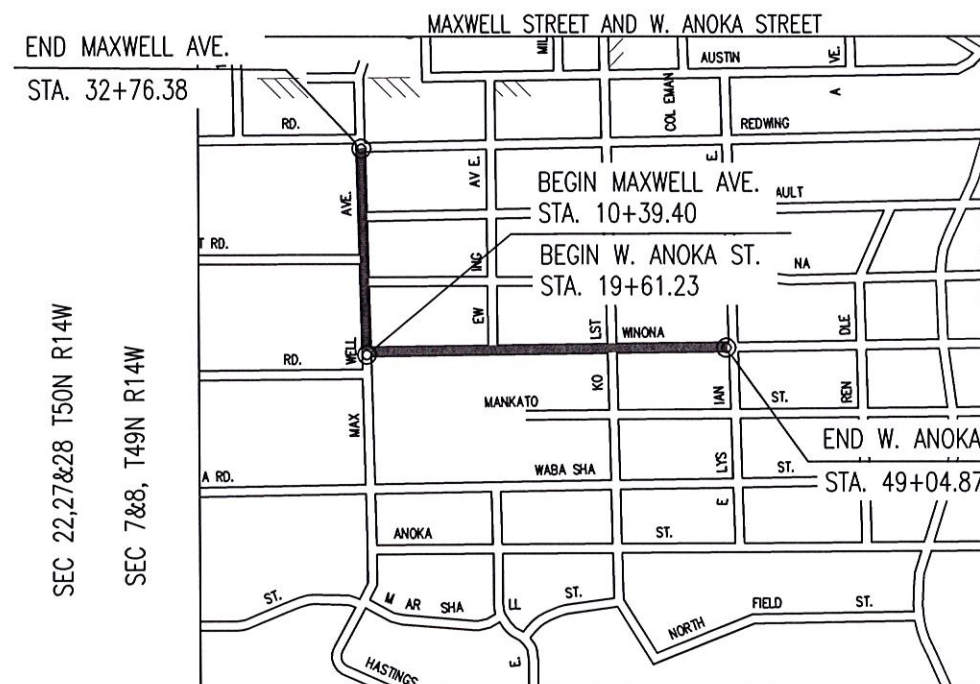

SCALE: 1" = 2250'

PLAN REVISIONS		
DATE	SHEET NO.	APPROVER

#### WARNING:

LOCATION OF UNDERGROUND UTILITIES TO BE VERIFIED BY CONTRACTOR.  
 CALL BEFORE DIGGING. GOPHER STATE ONE CALL 1-800-252-1166  
 REQUIRED BY LAW

CITY OF DULUTH PROJ. NO. \_\_\_\_\_

SHEET NO. \_\_\_\_\_ OF \_\_\_\_\_ SHEETS