



CITY OF DULUTH
CITY CLERK'S OFFICE
 330 City Hall • 411 West First Street
 Duluth, Minnesota 55802-1189
 Phone (218) 730-5500
 Fax (218) 730-5923

FOR OFFICE USE ONLY	
DATE	<u>3/15/18</u>
LICENSE #	<u>83</u>

Type in your information by tabbing through the boxes below.
 Print all forms, sign and submit to the address listed above.

LICENSE APPLICATION

LICENSE	FEE
TEMPORARY EXPANSION OF LICENSED PREMISES =	\$358.00
PLUS \$178.00 EACH ADDITIONAL DAY =	\$
TOTAL:	\$ 358.00

LICENSEE CORP NAME & BUSINESS ADDRESS:

Grandmas Angie's Inc.
525 Lake Ave. South
Duluth, MN 55802

D/B/A OR TRADE NAME: Little Angie's Cantina

CELL OR BUSINESS PHONE NO. 218-727-6117

MANAGER'S NAME & ADDRESS & PHONE #

Sandy Kolasinski
11 E. Buchanan St.
Duluth, MN 55802

EVENT LICENSE PERIOD: June 16, 2018

RAIN DATE? YES NO

IF YES, DATE: _____

NEW INFORMATION

- PLEASE NOTE:** All applications must be in the City Clerk's Office by the last Wednesday of the month. Your attendance at the AGTC meeting on the first Wednesday of the month is required. All information must be completed or it will be returned and may not be heard until the next months meeting. All diagrams, regardless if they are the same as last year must be redone each time you apply for a temporary expansion. Computer diagrams are allowed.
- SECURITY:** Supply information to the License Inspector (218-730-5421).
- HEALTH DEPT:** An application must be on file with the Minnesota State Health Department for the serving of food and alcohol (218-302-6166 or 218-302-6184).

I HEREBY STATE THAT ALL INFORMATION HERE IS TRUE AND CORRECT AND THAT I SHALL COMPLY WITH ALL PROVISION OF THE ORDINANCES OF THE CITY OF DULUTH AND LAWS OF THE STATE OF MINNESOTA AND THEIR AMENDMENTS.

Sandy Kolasinski
 Signature of Applicant

MAILING ADDRESS:

EMAIL: Sandyk@greecorp.com

Would you like notifications via email? YES NO

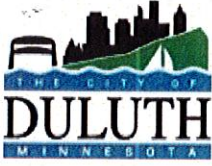

CITY OF DULUTH SUPPLEMENTAL FORM

Additional information is being required by the Duluth Police Department. An incomplete application will result in the delay or rejection of your application.

1. Is this the first time for this event? Yes No
If No, how many people attended this event 300
If Yes, how many people are you expecting to attend? _____
2. What kind of advertisement have you done? None
3. What is the age of the target group for this event? 21-50
4. Will alcohol be sold or given away at this event? YES
5. Will dancing be allowed at this event? NO

I understand that as the applicant for this permit/license, I am responsible for the Police/Security for this event. I will provide proof of hired security two weeks prior to the scheduled event.

Sandy Kolasmaki
Applicant Signature





3.13.18
Date

For office use only

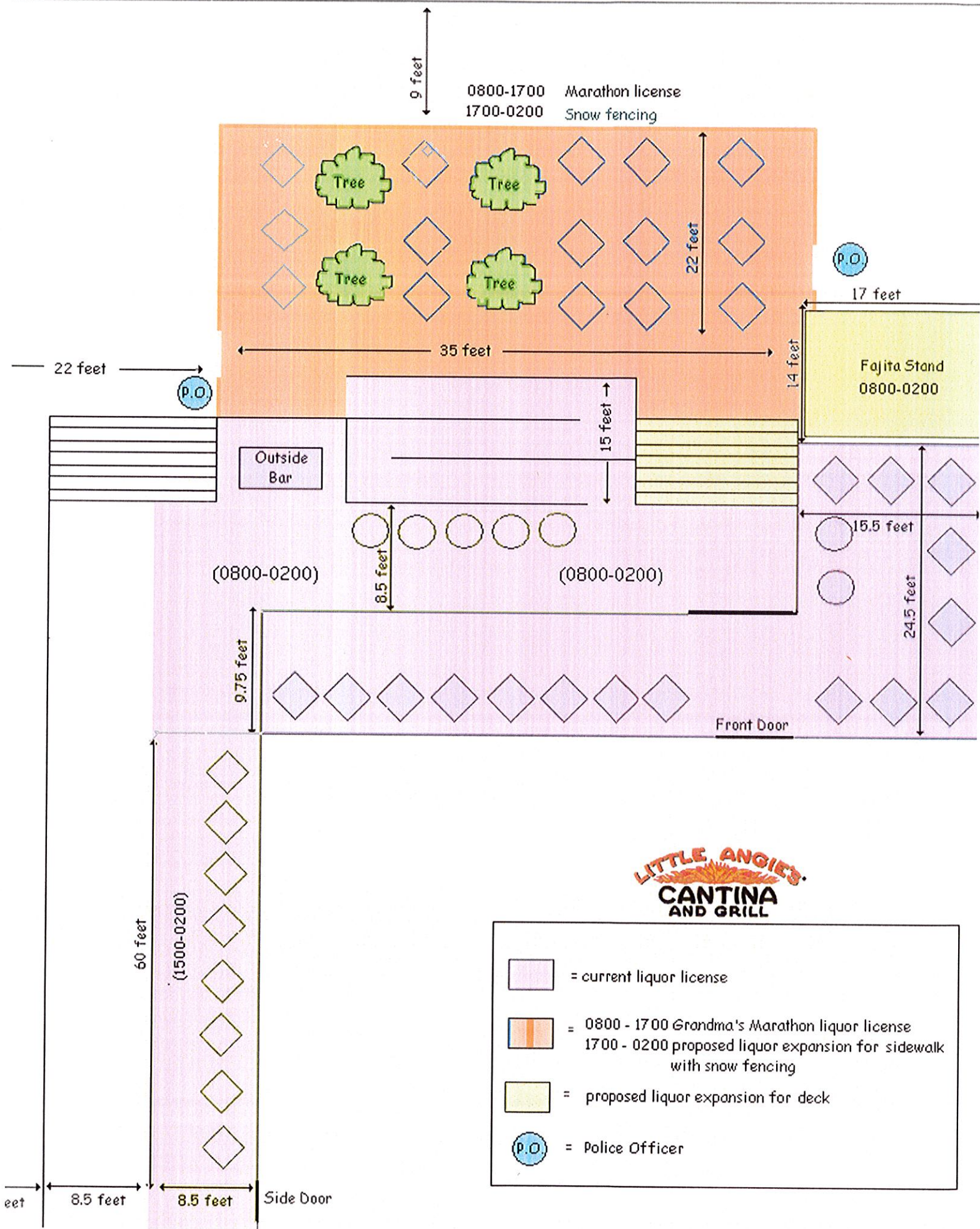
Is a licensed Peace Officer needed for this event? _____

If yes, how many licensed peace officers will be required? _____



	= current liquor license
	= 0800 - 1700 Grandma's Marathon liquor license 1700 - 0200 proposed liquor expansion for sidewalk with snow fencing
	= proposed liquor expansion for deck
	= Police Officer