

K:\Projects\1 - 40 CSAH\CSAH 37\SAP 069-637-027 - CP 0037-658738\400 Design\410 Drawings\520 Sheets\CP 0037-658738 Title sheet.dwg

PLAN SYMBOLS	
SECTION SUBDIVISION LINE	
EXISTING R/W	
NEW R/W	
TEMP EASE	
RAILROAD R/W	
ROAD SHOULDER	
EDGE OF LAKE	
SWAMP BOUNDARY	
MISCELLANEOUS BOUNDARY	
CORPORATE OR CITY LIMITS	
PROPERTY LINE	
RECREATIONAL TRAIL	
ROAD ALIGNMENT	
ALIGNMENT POINTS	
RIVER OR CREEK	
DRAINAGE DITCH	
BRIDGE	
RAILROAD (SINGLE TRACK)	
RR CROSSING PAVEMENT MARKING	
RR CROSSING GATE	
RR CROSSBUCK SIGN	
RR CROSSBUCK SIGN W/LIGHTS	
BARBED WIRE FENCE	
CHAIN LINK FENCE	
WOVEN WIRE, COMBINATION WOVEN AND BARB	
WOOD FENCE	
BILLBOARD	
RETAINING WALL	
GUARDRAIL (CABLE)	
GUARDRAIL (PLATE BEAM)	
DRAIN TILE	
CULVERT	
CULVERT WITH APRONS	
TREELINE OR BRUSHLINE	
DECIDUOUS TREES	
CONIFER (EVERGREEN) TREES	
HEDGE	
BUSH OR SHRUB	
SWAMP OR MARSH	
MONUMENT (C/ACT,ACP,BCP,...)	
CONCRETE OR STONE MONUMENT	
IRON PIPE, PIN OR REBAR	
IRON PIN WITH BRASS DISK	
NAIL, PK NAIL, SPIKE, SFP, T-BAR, ...	
VERTICAL CONTROL	
HORIZONTAL CONTROL	
POWER POLE	
LIGHT POLE	
LIGHT AND TELEPHONE POLE	
LIGHT, TELEPHONE AND POWER POLE	
GUY POLE	
POLE ANCHOR	
TELEPHONE POLE	
TELEPHONE AND POWER POLE	
UNDERGROUND UTILITY PEDESTAL	
TELEPHONE MANHOLE (VAULT)	
ELECTRIC CABLE IN CONDUIT	
TELEPHONE CABLE IN CONDUIT	
BURIED ELECTRIC CABLE	
BURIED TELEPHONE CABLE	
GAS LINE	
WATER LINE	
VALVE	
FIRE HYDRANT	
WATER MANHOLE	
WELL	
LAWN SPRINKLER HEAD	
MANHOLE	
CATCH BASIN	
SEPTIC TANK	
FORCE MAIN LIFT STA.	
SEWER LINE	
PERMANENT BARRICADE	
TRAFFIC SIGNAL LIGHT	
HAND HOLE	
ENTRANCE	
BUILDING	
SATELLITE DISH	
STEEL TOWER	
FLAG POLE	
SIGN	
TYPE III BARRICADE	
CHANNELIZING DEVICE	
TYPE A WARNING LIGHT	

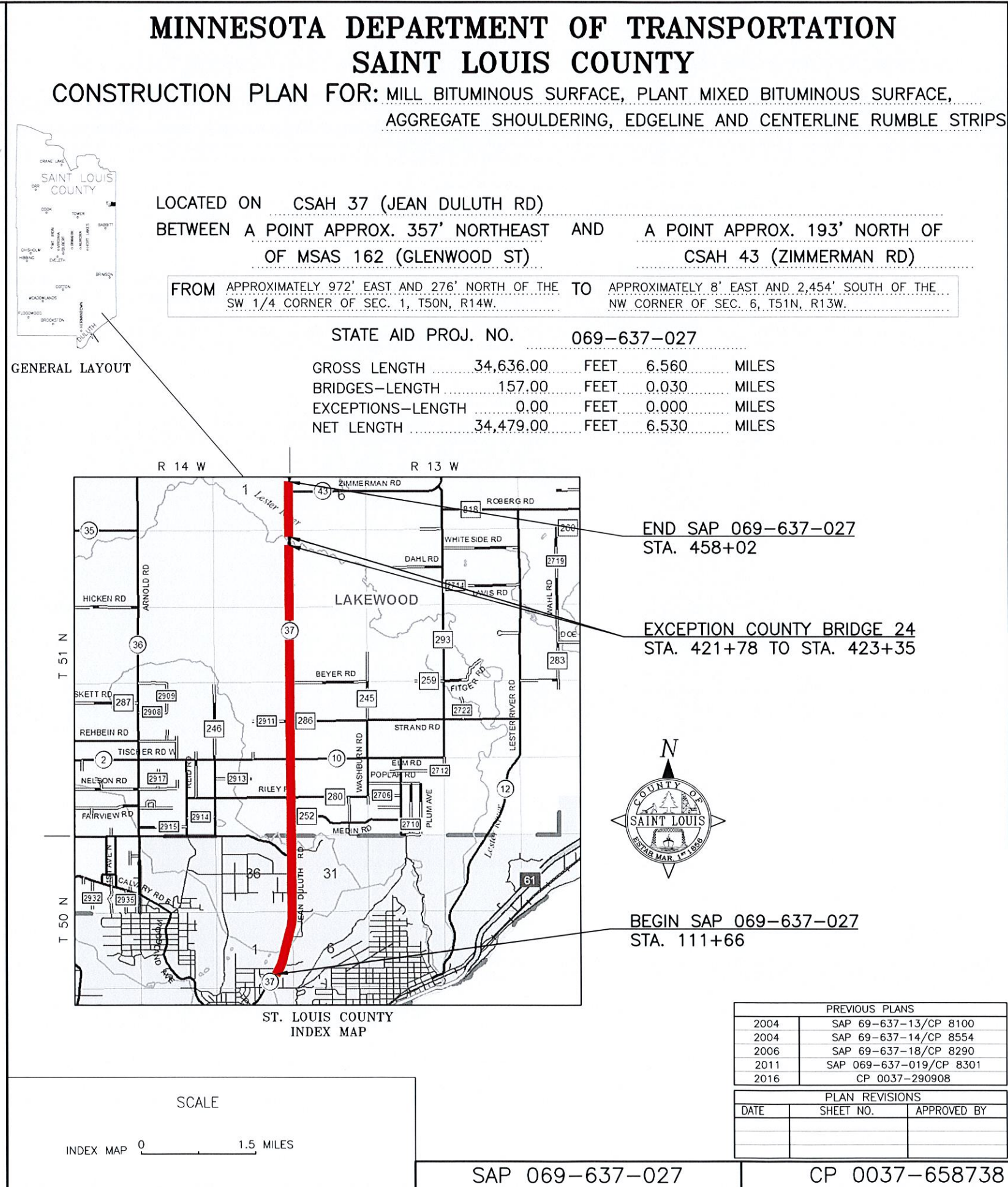

MINN. PROJ. NO.

GOVERNING SPECIFICATIONS

THE 2020 EDITION OF THE MINNESOTA DEPARTMENT OF TRANSPORTATION "STANDARD SPECIFICATIONS FOR CONSTRUCTION" SHALL GOVERN.  
AVAILABLE AT: <http://www.dot.state.mn.us/pre-letting/spec/index.html>

ALL TRAFFIC CONTROL SIGNING AND DEVICES SHALL CONFORM TO AND BE PLACED IN ACCORDANCE WITH THE MINNESOTA "MANUAL ON UNIFORM TRAFFIC CONTROL DEVICES" (MMUTCD) INCLUDING PART VI, THE CURRENT FIELD MANUAL, THE MINNESOTA STANDARD SIGNS MANUAL PARTS I, II, III, AND APPROPRIATE MATERIAL SPECIFICATIONS.

NO UTILITIES WILL BE AFFECTED BY THIS PROJECT

INDEX OF SHEETS

SHEET NO.	DESCRIPTION
1	TITLE SHEET AND INDEX MAP
2	STATEMENT OF ESTIMATED QUANTITIES
3-4	TYPICAL SECTIONS
5-6	QUANTITY CHARTS
7-9	RUMBLE STRIP DETAILS
10	PAVEMENT MARKINGS
11-12	TRAFFIC CONTROL

THIS PLAN CONTAINS 12 SHEETS

DESIGN DESIGNATION

ADT (CURRENT YEAR)	2022	=	6,695
ADT (FUTURE YEAR)	2042	=	7,365
D (DIRECTIONAL DISTR.)		=	50/50%
T (HEAVY COMMERCIAL - 8.6%)		=	634
PROJ. SOIL FACTOR		=	100
TRAFFIC LANE WIDTH		=	12.0'
SHOULDER WIDTH		=	4.0'-8.0' PAVED, 2.0' GRAVEL
FUNCTIONAL CLASSIFICATION		=	MINOR ARTERIAL/MAJOR COLLECTOR
DESIGN LOADING		=	10 TON

DESIGNERS SOUTH DESIGN (ZB, AL)

I HEREBY CERTIFY THAT THIS PLAN WAS PREPARED BY ME OR UNDER MY DIRECT SUPERVISION AND THAT I AM A DULY LICENSED PROFESSIONAL ENGINEER UNDER THE LAWS OF THE STATE OF MINNESOTA.

PRINT NAME: STEPHEN E. KRASAWAY

SIGNATURE: \_\_\_\_\_

DATE: \_\_\_\_\_ LIC. NO. 45397

APPROVED \_\_\_\_\_ ST. LOUIS CO. HWY. ENGINEER DATE \_\_\_\_\_

DISTRICT STATE AID ENGINEER: REVIEWED FOR COMPLIANCE WITH STATE AID RULES AND POLICIES DATE \_\_\_\_\_

STATE AID ENGINEER: APPROVED FOR STATE AID FUNDING DATE \_\_\_\_\_

SAP 069-637-027 CP 0037-658738 SHEET NO. 1 OF 12 SHEETS