



**CITY OF DULUTH  
CITY CLERK'S OFFICE**

330 City Hall • 411 West First Street  
Duluth, Minnesota 55802-1189  
Phone (218) 730-5500  
Fax (218) 730-5923

FOR OFFICE USE ONLY

DATE 5-22-17

LICENSE # 73

Type in your information by tabbing through the boxes below.  
Print all forms, sign and submit to the address listed above.

**LICENSE APPLICATION**

LICENSE	FEE
TEMPORARY EXPANSION OF LICENSED PREMISES =	\$358.00
PLUS \$178.00 EACH ADDITIONAL DAY =	\$
TOTAL:	\$

LICENSEE CORP NAME & BUSINESS ADDRESS:

Chasers of Duluth, INC  
2023 W Superior St  
Duluth MN 55806

D/B/A OR TRADE NAME:

Bedrock Bar

CELL OR BUSINESS PHONE NO.

218 393 6842

MANAGER'S NAME & ADDRESS & PHONE #

Tammi Behson  
1206 N 8th St  
Superior WI 54880  
218 393 6842

EVENT LICENSE PERIOD:

Sat June 17 2017

RAIN DATE?

YES

☐

NO

☒

IF YES, DATE:

\_\_\_\_\_

**NEW INFORMATION**

- PLEASE NOTE:** All applications must be in the City Clerk's Office by the last Wednesday of the month. Your attendance at the AGTC meeting on the first Wednesday of the month is required. All information must be completed or it will be returned and may not be heard until the next months meeting. All diagrams, regardless if they are the same as last year must be redone each time you apply for a temporary expansion. Computer diagrams are allowed.
- SECURITY:** Supply information to the License Inspector (218-730-5421).
- HEALTH DEPT:** An application must be on file with the Minnesota State Health Department for the serving of food and alcohol (218-302-6166 or 218-302-6184).

I HEREBY STATE THAT ALL INFORMATION HERE IS TRUE AND CORRECT AND THAT I SHALL COMPLY WITH ALL PROVISION OF THE ORDINANCES OF THE CITY OF DULUTH AND LAWS OF THE STATE OF MINNESOTA AND THEIR AMENDMENTS.

Signature of Applicant

MAILING ADDRESS:

2023 W Superior  
Duluth MN  
55806

EMAIL:

Would you like notifications via email?

☐

YES

☒

NO



Date of Application \_\_\_\_\_

License No. \_\_\_\_\_

### TEMPORARY EXPANSION OF LICENSED PREMISES (DIAGRAM)

Owner: \_\_\_\_\_ (d/b/a) Trade Name: Bedrock Bar  
Date of Event: Sat June 17 Address: 2023 W. Superior St  
Name of Event: LINCOLN Park Fishing Contest Time of Event: PM 5:30-9:00 PM  
Security Personnel: DPD Firm: DPD

#### DIAGRAM MUST SHOW:

- A. Area that will be used.
- B. Streets and intersections bordering the area.
- C. Where fencing surrounding the area will be located and what type of fencing will be used (snow fence is preferred).
- D. Where the bar will be located in the "serving area."
- E. Exits and entries to and from the "serving area."

Sketch location and dimensions of area to be occupied. Indicate north on diagram as "NORTH."

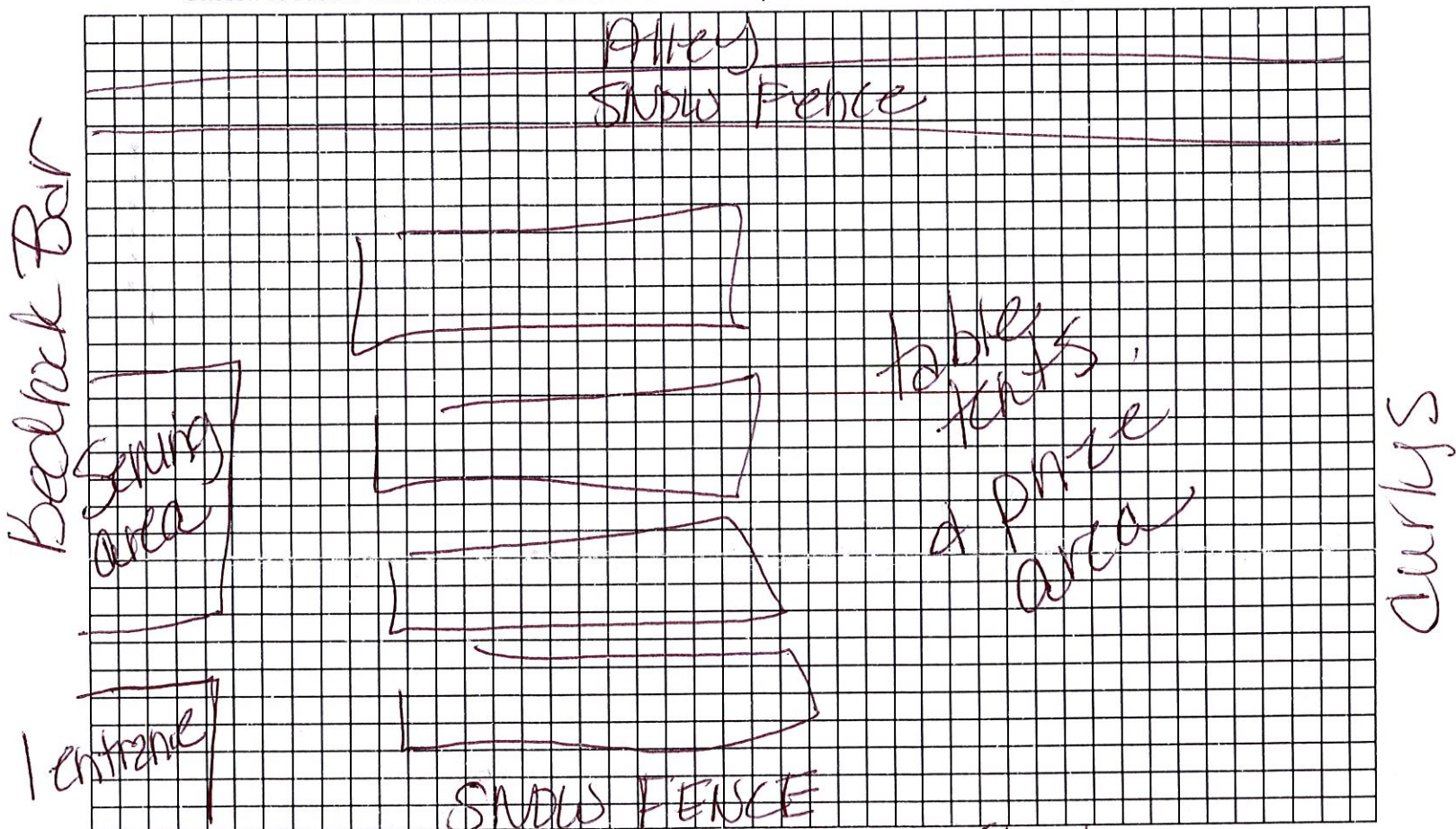

I hereby agree that I shall comply with all of the ordinances of the City of Duluth and laws of the State of Minnesota and their amendments. I further agree to comply with any special restrictions which may be imposed by resolution of the Duluth City Council and not to allow any services or consumption outside of the approved "designated serving area" identified here.

Signature of owner/authorized representative

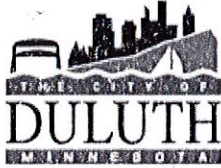

## CITY OF DULUTH SUPPLEMENTAL FORM

**Additional information is being required by the Duluth Police Department. An incomplete application will result in the delay or rejection of your application.**

1. Is this the first time for this event?

Yes ☐ No ☒

If No, how many people attended this event

100-300

If Yes, how many people are you expecting to attend?

\_\_\_\_\_

2. What kind of advertisement have you done? \_\_\_\_\_

word of mouth, email, banner, flyers

3. What is the age of the target group for this event?

30-50

4. Will alcohol be sold or given away at this event?

yes

5. Will dancing be allowed at this event?

no

I understand that as the applicant for this permit/license, I am responsible for the Police/Security for this event. I will provide proof of hired security two weeks prior to the scheduled event.

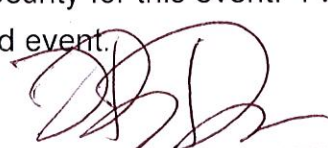
  
Applicant Signature

5-11-17  
Date

### For office use only

Is a licensed Peace Officer needed for this event? \_\_\_\_\_

If yes, how many licensed peace officers will be required? \_\_\_\_\_