

Date of Application _____

License No. _____

TEMPORARY EXPANSION OF LICENSED PREMISES (DIAGRAM)

Owner: Bob Monahan (d/b/a) Trade Name: The Red Herring Lounge
Date of Event: 8/19/17 Address: 200 block of E 1st St.
Name of Event: Super Big Block Party Time of Event: 12pm - 10pm
Security Personnel: 10 Firm: in-house

DIAGRAM MUST SHOW:

- A. Area that will be used.
- B. Streets and intersections bordering the area.
- C. Where fencing surrounding the area will be located and what type of fencing will be used (snow fence is preferred).
- D. Where the bar will be located in the "serving area."
- E. Exits and entries to and from the "serving area."

— fencing (bike rack)
— expansion area

Sketch location and dimensions of area to be occupied. Indicate north on diagram as "NORTH."

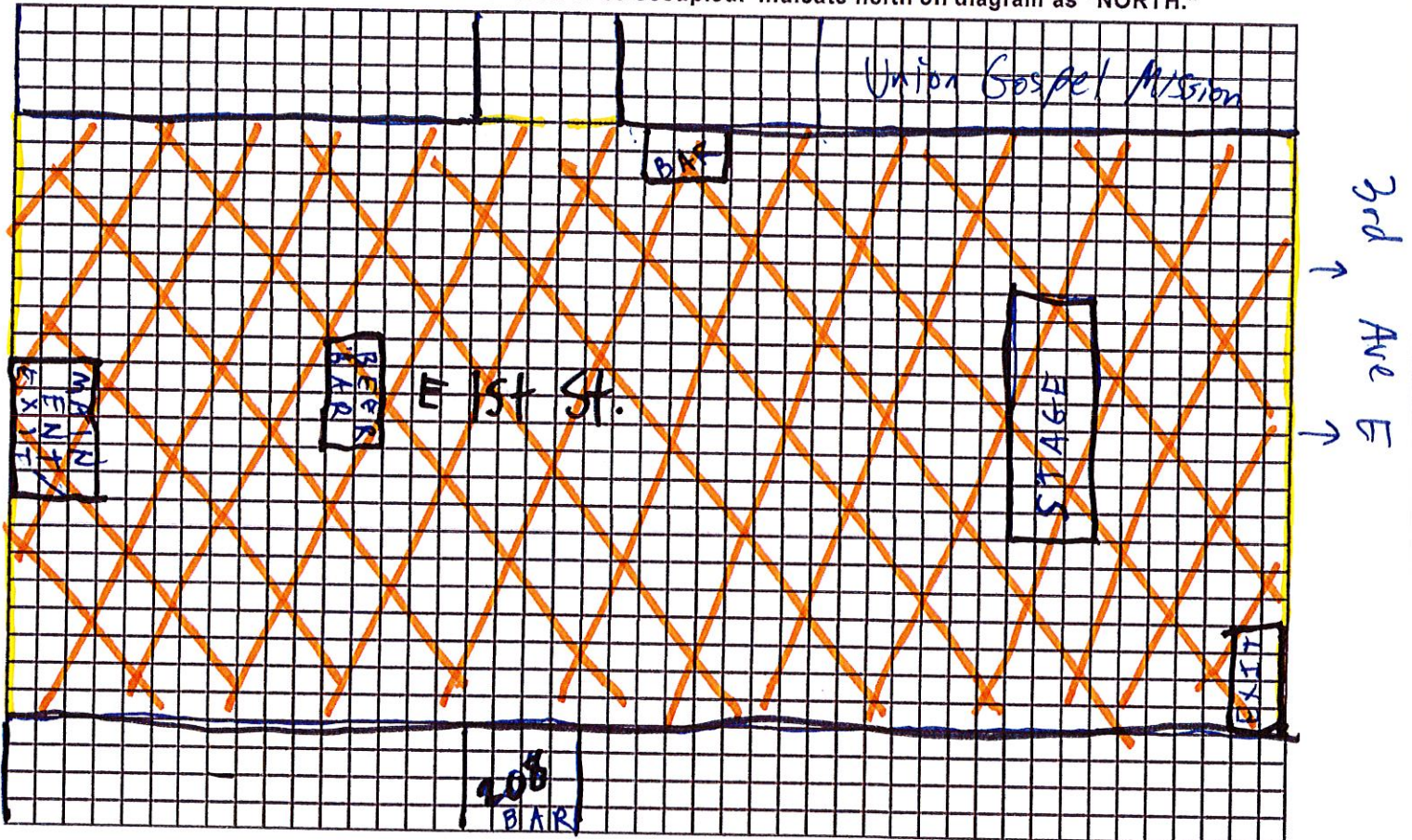

I hereby agree that I shall comply with all of the ordinances of the City of Duluth and laws of the State of Minnesota and their amendments. I further agree to comply with any special restrictions which may be imposed by resolution of the Duluth City Council and not to allow any services or consumption outside of the approved "designated serving area" identified here.

[Signature]
Signature of owner/authorized representative